



About us :

Zitto Architecture Hardware established by a team of Professionals, having experience more than 30 years in the field of furniture and glass architectural hardware industry, with global vision.



Zitto In Brief

- Zitto as a brand can be used in all sectors of the industry like personal homes, residential projects, commercial projects etc.
- Zitto desires equally major share in retail and oem segment with lot of products range under one roof.

Mission :

- Best Customer Service.
- Fulfill all commitment with profitable growth of our channel partners and company.

Vision :

- To be India's leading company in retail & oem segment with the presence across India.
- Continue new invention for new generation & fulfill all needs of respective market, along with social service & skill development programs.
- Pleasant working environment to employees with respective growth.

Floor Spring Series



Silent



Smartness



Long-Lasting

- Zitto floor hinges series is suitable for all types of commercial & residential areas in variant sizes.



Zitto[®]
Architecture Hardware



ZFS01

Floor Spring

SPECIFICATIONS

- Floor Hinge for Glass & Wooden Doors
- Door Weight Capacity: 80 Kg
- Maximum Door Width: 900mm
- Hold Open : 90°
- Tested : 5,00,000 Cycles
- Installation Dimension : L-251,W-110, H-51mm
- Finish : SSS

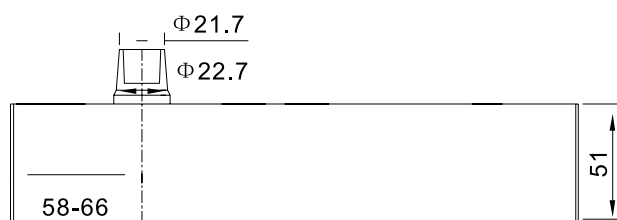
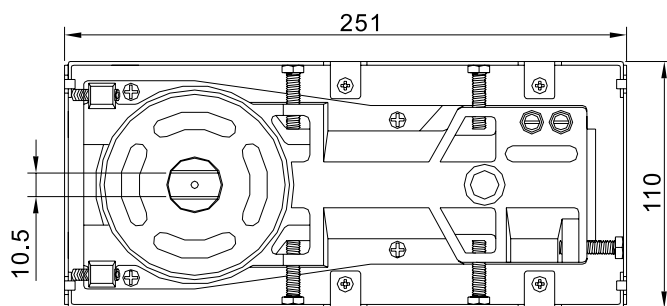

1. Select the high quality steel for transmission parts. The service life of Italy oil seal is over half a million times.
2. General designed is suitable for opening doors with left/right hand and single opening.
3. Filled with high quality anti-icing hydraulic oil, ensuring that closing speed won't be affected at minus 20 degrees.
4. Can adjust 5 mm all around in the metal box, and adjust $\pm 2^\circ$ in longitudinal direction during zero calibration, making installation easier.
5. Applicable in all public glass & wooden doors.

Door weight	80kg
Dimension of appearance	251x110x51mm
Suitable for door size	900x2100mm
Location degree	90°
Double action door	<input checked="" type="checkbox"/>
2 Section speed adjustment valve	<input checked="" type="checkbox"/>

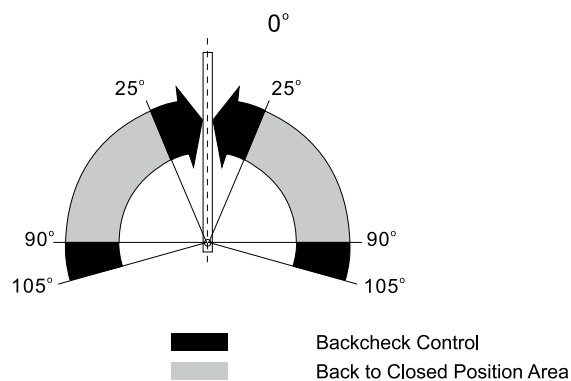



ZFS02

Floor Spring

SPECIFICATIONS

- Maximum Door Weight : 100 Kg
- Maximum Door Width : 1000mm
- Hold Open : 90°
- Tested : 5,00,000 Cycles
- Installation Dimension : L-306, W-109, H-41mm
- Finish : SSS



INSTALLATION DETAILS :

- (A) Draw lines and make floor spring pivot center and door-nip pivot coincide with each other.
- (B) Drill holes on the floor according to the instructions, The size of the holes must tightly match the floor spring.
- (C) Place the floor spring into the holes and position it.
- (D) Raise the door leaf installed with door-nip, and insert the floor spring pivot into the hole for the door leaf.
- (E) Adjust the screws at three directions. Make them vertical and the upper & lower pivot center coincide with each other.
- (F) Adjust the speed of door closing.
- (G) Put the decoration cover on the floor spring.

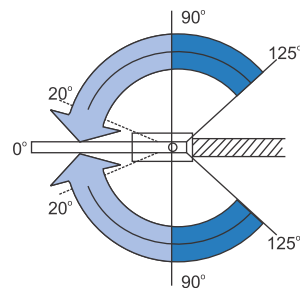
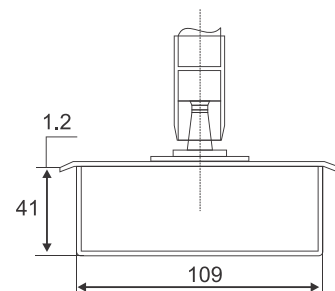
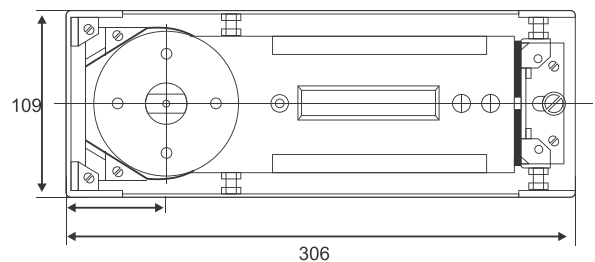
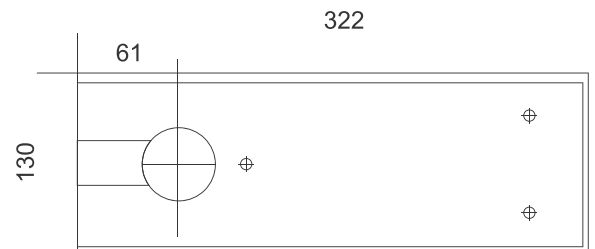

- Buffer Zone
- Back to Close Position Area



Product Name	Pcs/Ctn
Wooden Door Accessories Top & Bottom (Gold)	4
Wooden Door Accessories Top & Bottom (Silver)	4





ZFS03

Floor Spring

SPECIFICATIONS

- Maximum Door Weight : 120 Kg
- Maximum Door Width : 1100mm
- Hold Open : 90°
- Tested : 5,00,000 Cycles
- Installation Dimension : L-306, W-109, H-41mm
- Finish : SSS



INSTALLATION DETAILS :

- (A) Draw lines and make floor spring pivot center and door-nip pivot coincide with each other.
- (B) Drill holes on the floor according to the instructions, The size of the holes must tightly match the floor spring.
- (C) Place the floor spring into the holes and position it.
- (D) Raise the door leaf installed with door-nip, and insert the floor spring pivot into the hole for the door leaf.
- (E) Adjust the screws at three directions. Make them vertical and the upper & lower pivot center coincide with each other.
- (F) Adjust the speed of door closing.
- (G) Put the decoration cover on the floor spring.

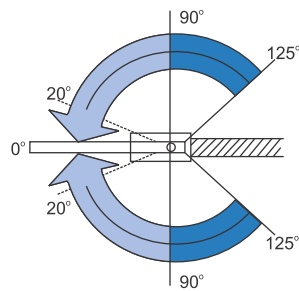
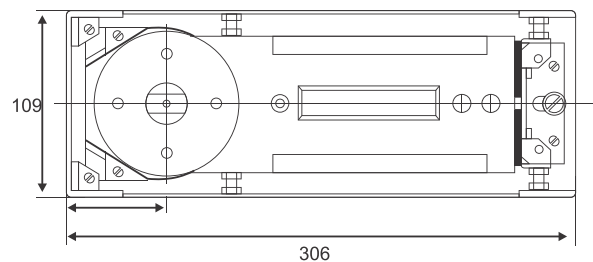
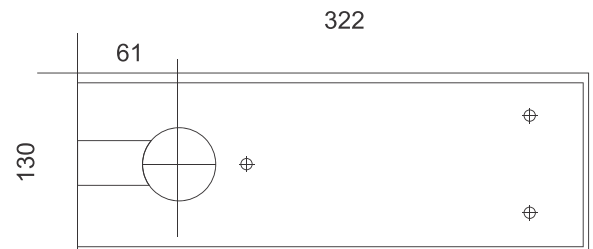

- Buffer Zone
- Back to Close Position Area

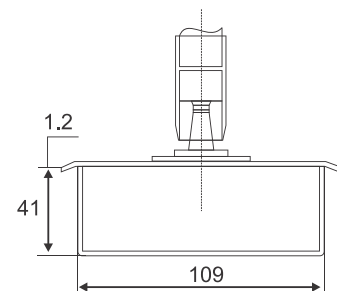



ZFS04

Floor Spring

SPECIFICATIONS



- Maximum Door Weight : 150 Kg
- Maximum Door Width : 1200mm
- Hold Open : 90°
- Tested : 5,00,000 Cycles
- Installation Dimension : L-306, W-109, H-41mm
- Finish : SSS

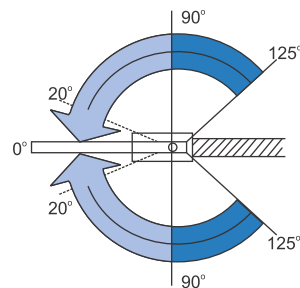
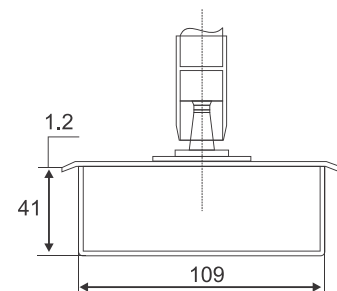
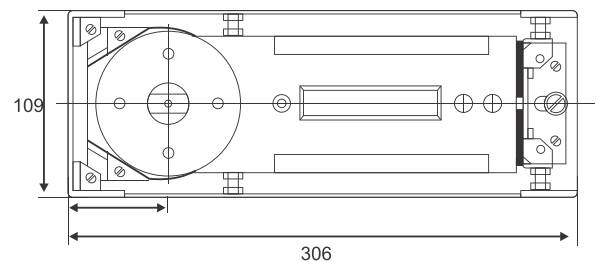
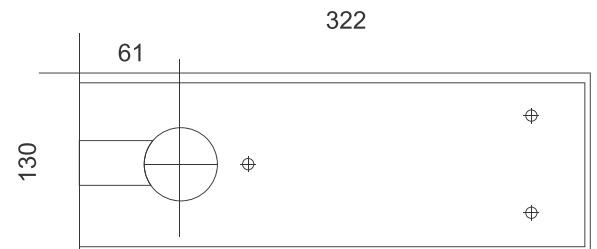

INSTALLATION DETAILS :

- Draw lines and make floor spring pivot center and door-nip pivot coincide with each other.
- Drill holes on the floor according to the instructions, The size of the holes must tightly match the floor spring.
- Place the floor spring into the holes and position it.
- Raise the door leaf installed with door-nip, and insert the floor spring pivot into the hole for the door leaf.
- Adjust the screws at three directions. Make them vertical and the upper & lower pivot center coincide with each other.
- Adjust the speed of door closing.
- Put the decoration cover on the floor spring.



-  Buffer Zone
-  Back to Close Position Area



ZFS05 Floor Spring

SPECIFICATIONS

- Maximum Door Weight : 300 Kg
- Maximum Door Width : 1500mm
- Hold Open : 90°
- Tested : 5,00,000 Cycles
- Installation Dimension : L-326, W-138, H-41mm
- Finish : SSS

INSTALLATION DETAILS :

- Draw lines and make floor spring pivot center and door-nip pivot coincide with each other.
- Drill holes on the floor according to the instructions, The size of the holes must tightly match the floor spring.
- Place the floor spring into the holes and position it.
- Raise the door leaf installed with door-nip, and insert the floor spring pivot into the hole for the door leaf.
- Adjust the screws at three directions. Make them vertical and the upper & lower pivot center coincide with each other.
- Adjust the speed of door closing.
- Put the decoration cover on the floor spring.

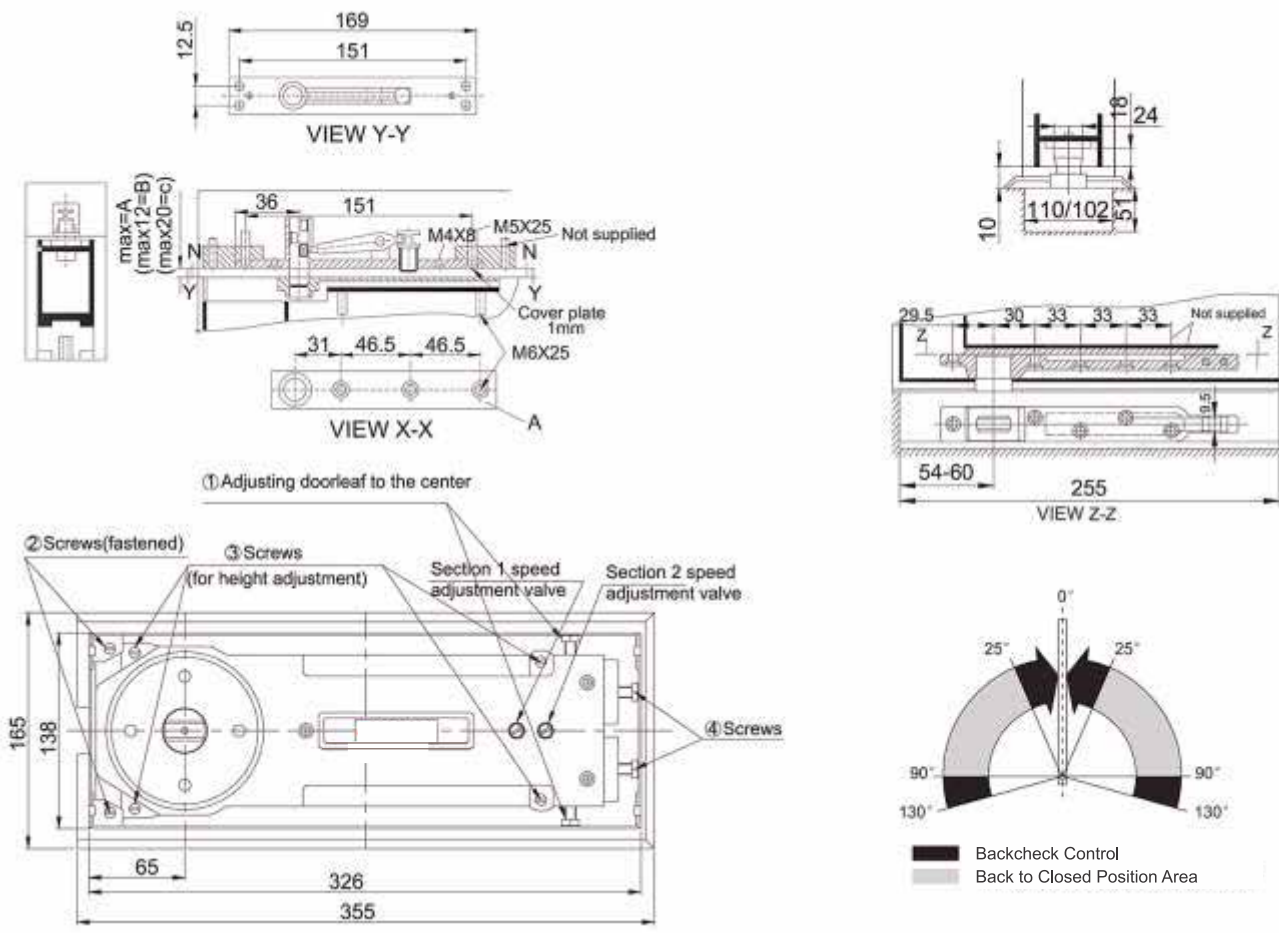

ZFS06

Hydraulic Patch



SPECIFICATIONS

- Quick and Easy Installation
- Weight Capacity: Max 100kg.
- Maximum Door Width: 1000mm
- Thickness: 8-12mm
- Ambient Temperature : -20° C to +50° C
- Easy Installation with Base Seat
- Tested : 5,00,000 Cycles
- Finish : SSS

HYDRAULIC PATCH

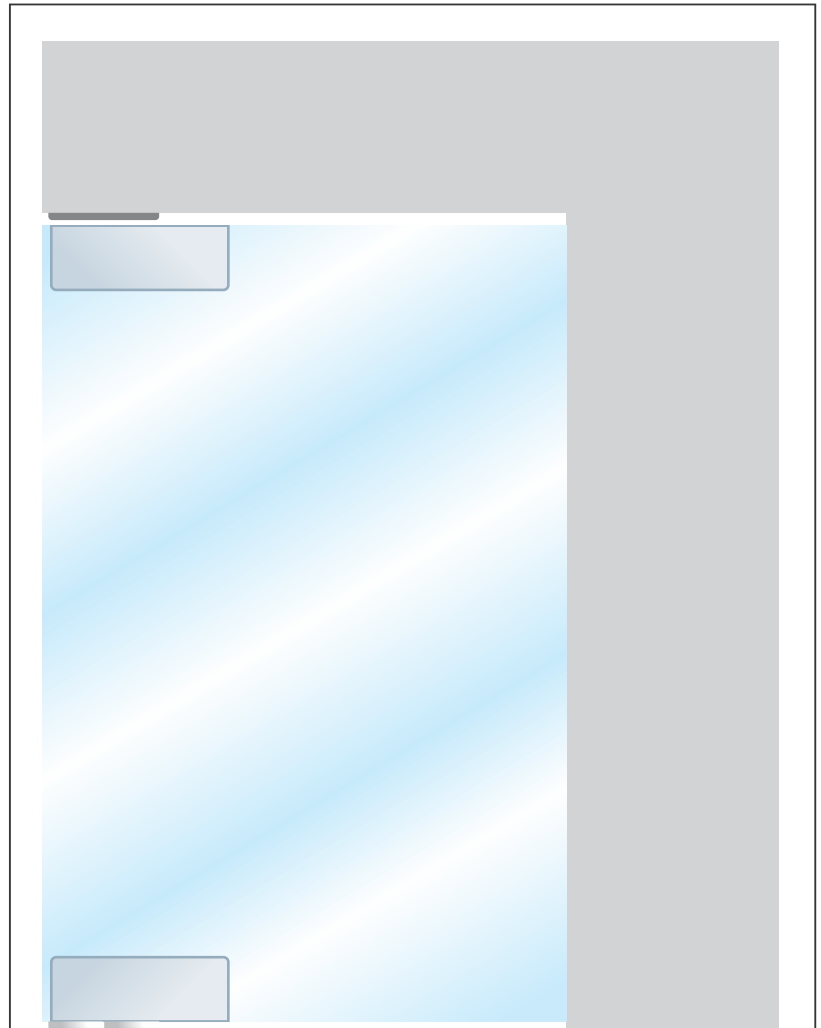
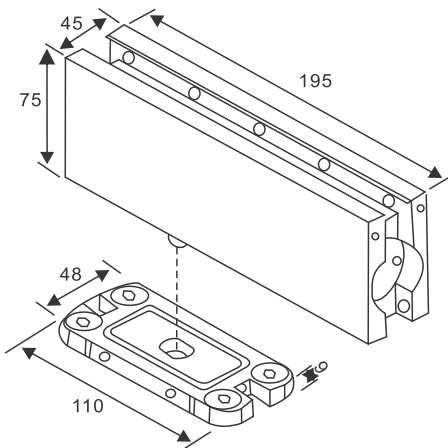
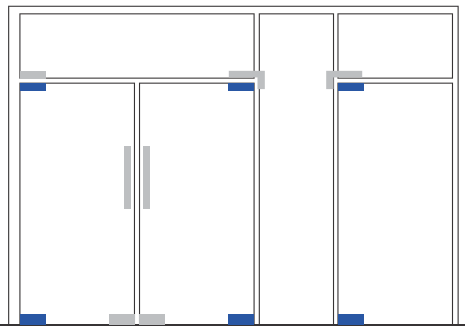
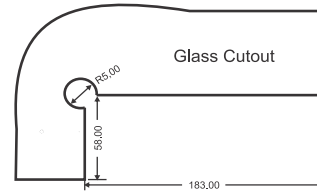



Patch Fitting

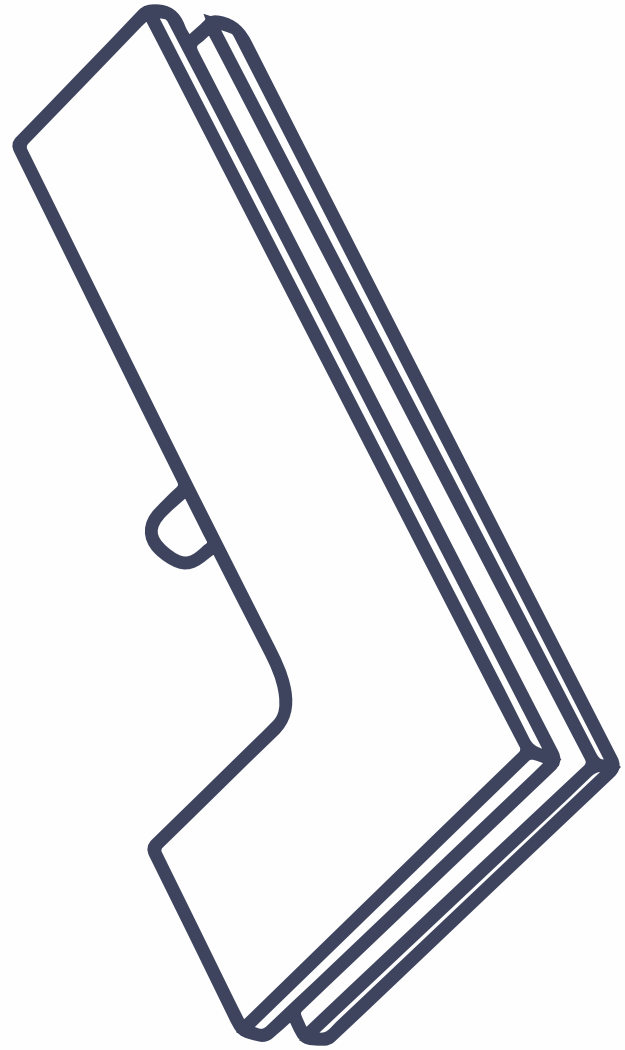

ZITTO Patch Fittings, High-strength alloy die-cast body assures safety and durability. Decorative case punched precisely of Stainless Steel 304 grade. The pads are made of particular oxidation resisting material. Suitable for toughened glass door with the thickness of 10-12mm (can also be the order as per customer's specifications).



Silent



Smartness



Long-Lasting



Zitto[®]
Architecture Hardware





ZPF01

Bottom Patch

Secured on to the Bottom of the Door Leaf to accept the Spindle of Nozduk floor springs

Specifications

- With stainless steel 304 cover
- Cover secured with small 'L' key
- Adjustable pivot point 55/65 mm
- Stainless steel finish

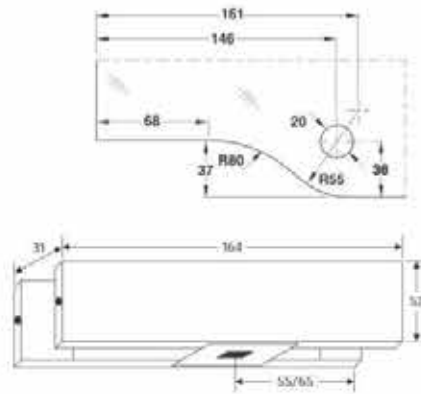

ZPF02

Top Patch

Secured on to the Door Leaf Top to accept the Pivot of NPF-290 or NPF-60

Specifications

- With stainless steel 304 cover
- Cover secured with small 'L' key
- Adjustable pivot point 55/65 mm
- Stainless steel finish

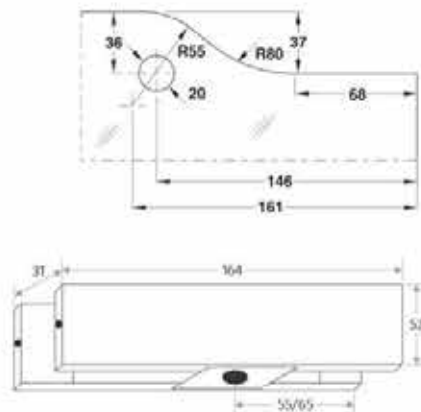



ZPF03
Bottom Lock

To Lock swing door on Floor/Ceiling
Specifications

- With a euro profile cylinder & strike plate
- Dead bolt projection of 15mm (single throw)
- Three high security computer keys
- With stainless steel 304 cover
- Cover secured with small 'L' key
- Stainless steel finish

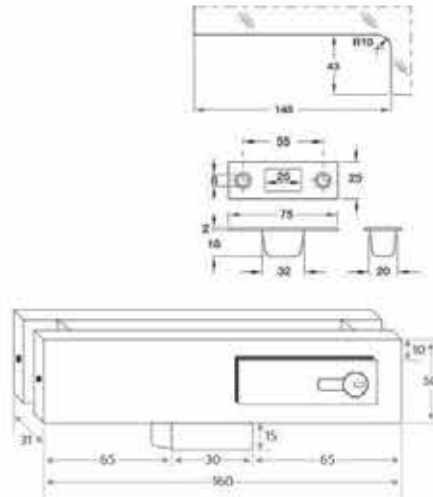

ZPF04
Small Gun

Patch to secure the Over panel and Side panel at the opening edge of the door
Specifications

- With stainless steel 304 cover
- Cover secured with small 'L' key
- Stainless steel finish

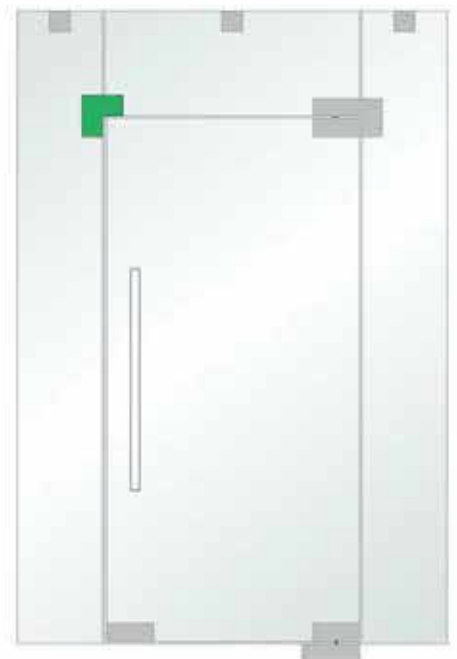
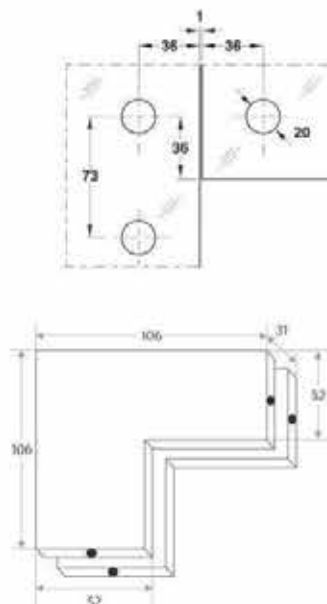



ZPF05

Big Gun

Connector over panel and side panel with pivot
Specifications

- With stainless steel 304 cover
- Cover secured with small 'L' key
- Pivot pin of 15mm diameter
- Adjustable pivot point 55/65 mm
- Stainless steel finish

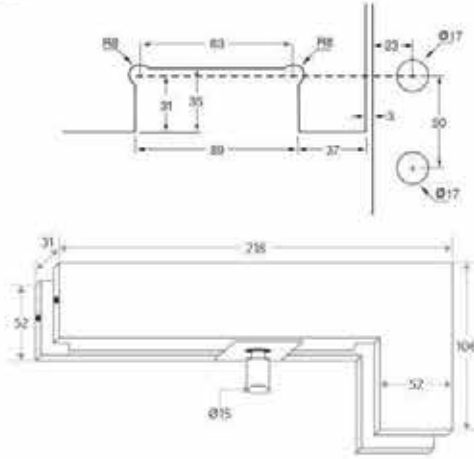

ZPF06

Over Panel Patch

Over panel with pivot
Specifications

- Over panel Patch
- With stainless steel 304 cover
- Cover secured with small 'L' key
- Adjustable pivot point 55/65 mm
- Stainless steel finish

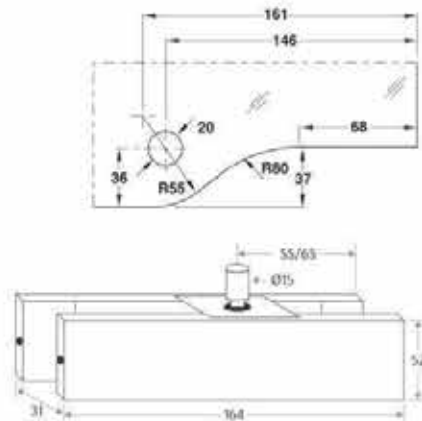



ZPF07

9 Center Patch Lock

Suitable to lock swing door

Specifications

- Can also be use to lock doors from center.
- With a euro profile cylinder and strike plate
- With 3 high security computerized keys
- Single throw rectangular bolt with 15mm projection
- With stainless steel 304 cover
- High quality temperd precision screws are used to ensure solid griping
- Stainless steel finish

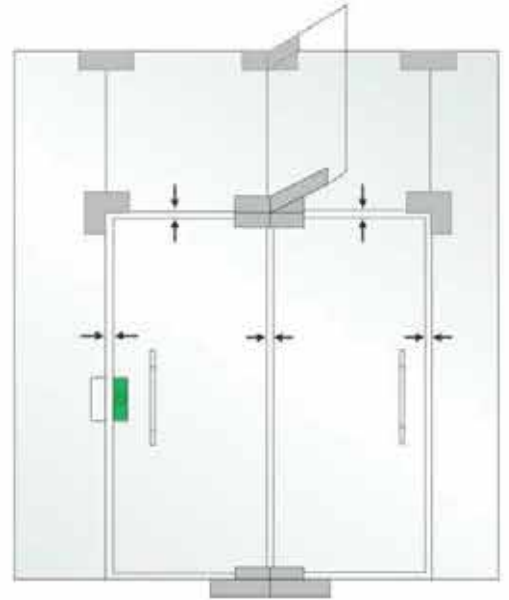
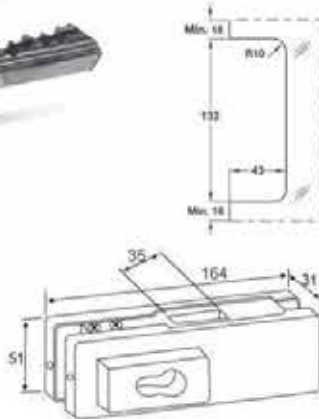

ZPF08

Center Lock Strike Box

Suitable to lock double door

Specifications

- Can also be use to lock doors from center.
- Strike box for NPF-70
- With stainless steel 304 cover
- High quality temperd precision screws are used to ensure solid griping
- Stainless steel finish

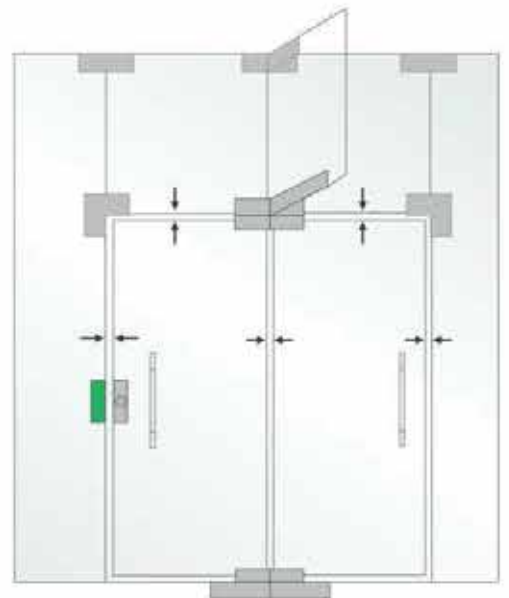
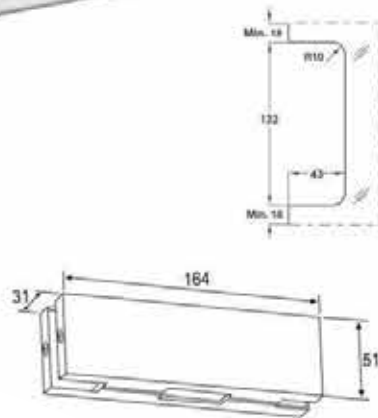



ZPF09

Big L With Fix (Left)

Suitable for fixing over panel & side panel along with fin
Specifications

- Over panel side panel with fin inside
- With stainless steel 304 cover
- High quality temperd precision screws are used to ensure solid griping
- Stainless steel finish

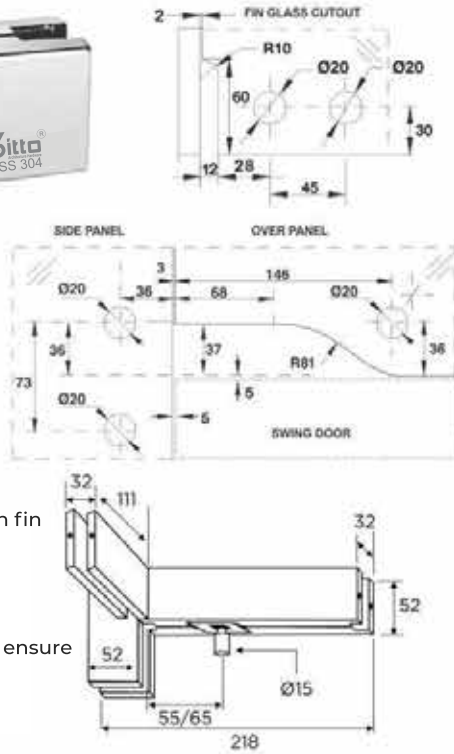

View from outside with Fin on the inside



ZPF10

Big L With Fix (Right)

Suitable for fixing over panel & side panel along with fin
Specifications

- Over panel side panel with fin inside
- With stainless steel 304 cover
- High quality temperd precision screws are used to ensure solid griping
- Stainless steel finish

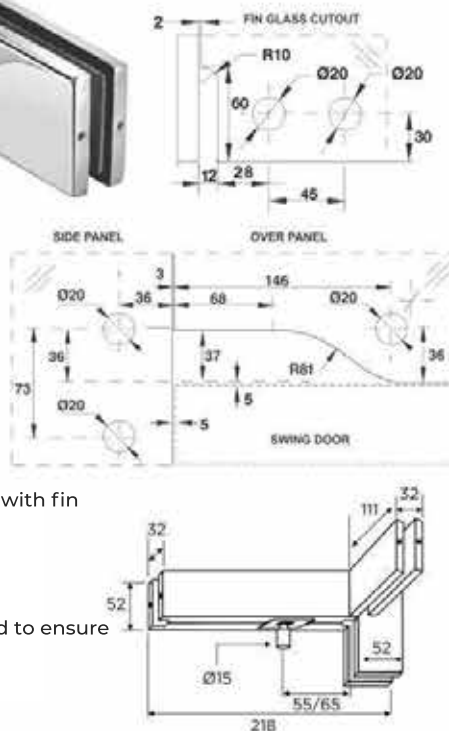

View from outside with Fin on the inside

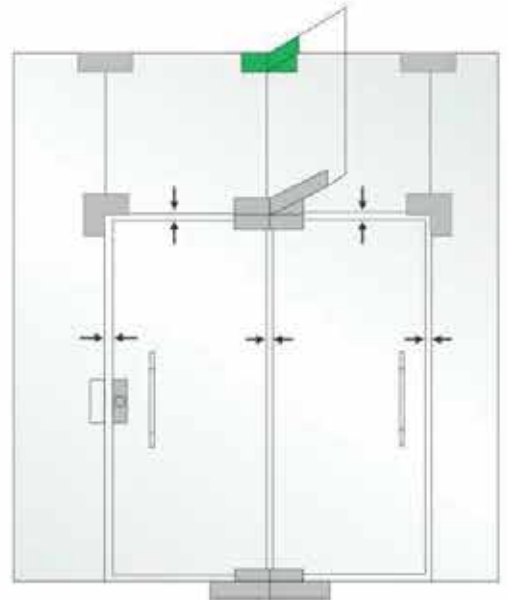
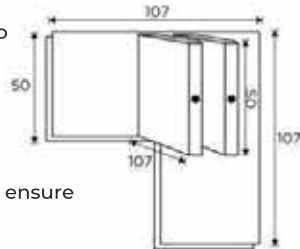
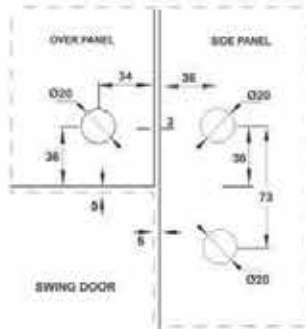
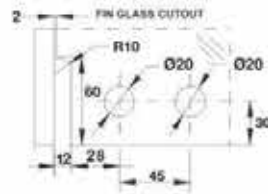

ZPF11

Triple Glass Connector with Fin (Left)

Suitable for fixing over panel & side along with fin to be used at the opening top corner of the door.

Specifications

- Over panel side panel with fin inside
- With stainless steel 304 cover
- High quality tempered precision screws are used to ensure solid gripping
- Stainless steel finisa

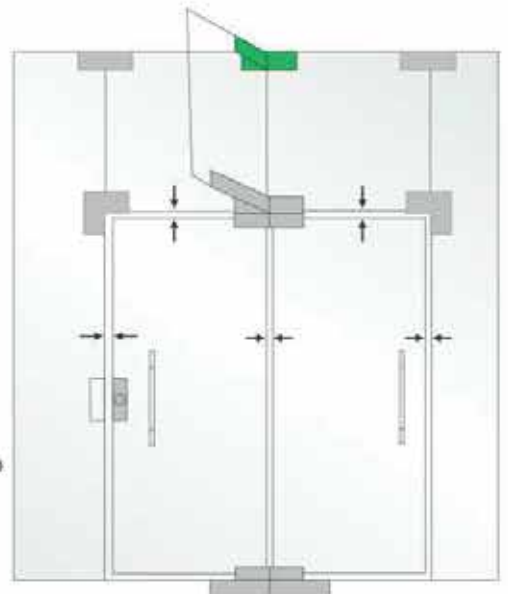
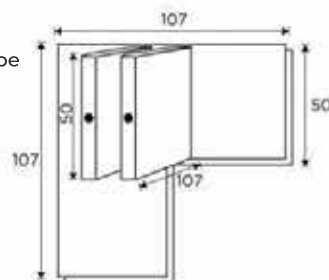
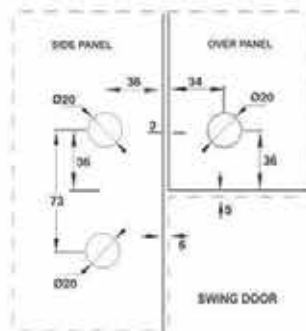
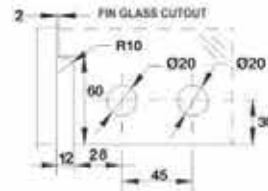

ZPF12

Triple Glass Connector with Fin (Right)

Suitable for fixing over panel & side along with fin to be used at the opening top corner of the door.

Specifications

- Over panel side panel with fin inside
- With stainless steel 304 cover
- High quality tempered precision screws are used to ensure solid gripping
- Stainless steel finish



ZPF13

Connector with Fin

Suitable for fixing two fixed glasses in line with fin inside

Specifications

- With stainless steel 304 cover
- For fixing two glass in line with fin inside
- High quality tempered precision screws are used to ensure solid gripping
- Stainless steel finish

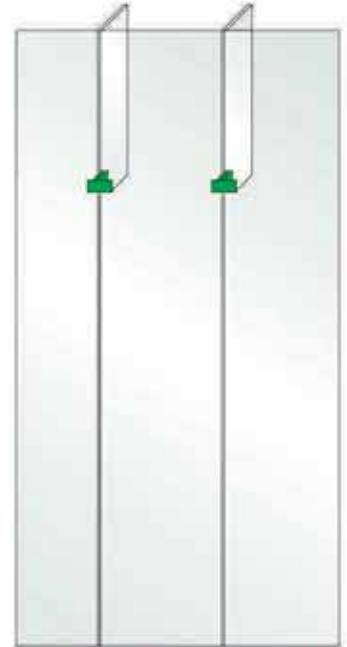
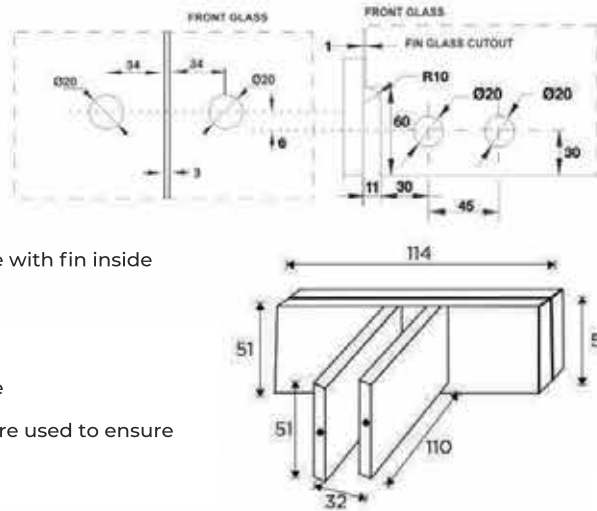

View from outside with Fin on the inside



ZPF14

Glass to Glass Connecting Patch with Wall/Ceiling

Suitable for fixing two fixed glasses together with ceiling, floor & wall

Specifications

- With stainless steel 304 cover
- High quality tempered precision screws are used to ensure solid gripping
- Stainless steel finish

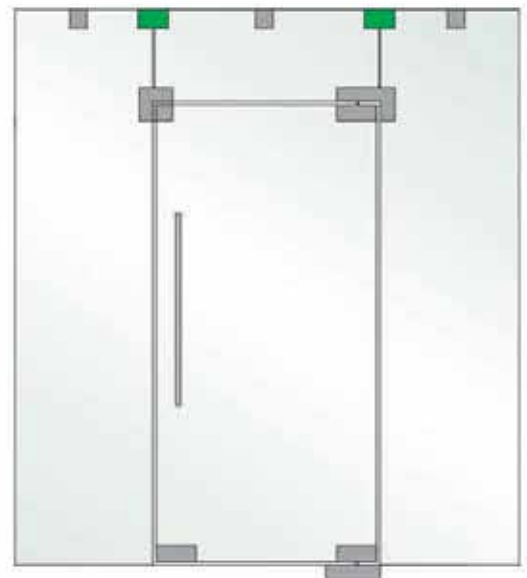
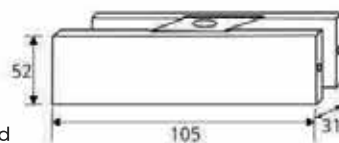
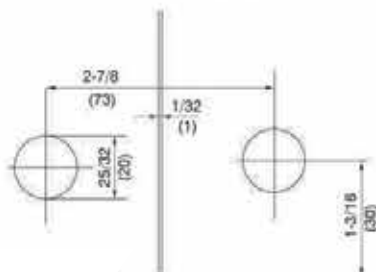
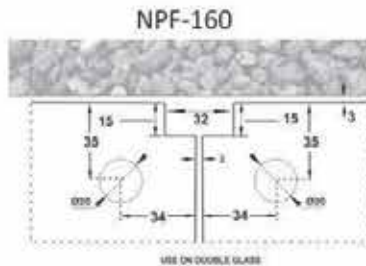



ZPF15

Over Panel Side Panel Patch Connector with Stopper

Suitable for fixing over panel & side panel at the opening top corner of the door also restricts one side opening of the door

Specifications

- With stainless steel 304 cover
- Square look from one side & L shape from another side
- High quality tampered precision screws are used to ensure solid gripping
- Stainless steel finish

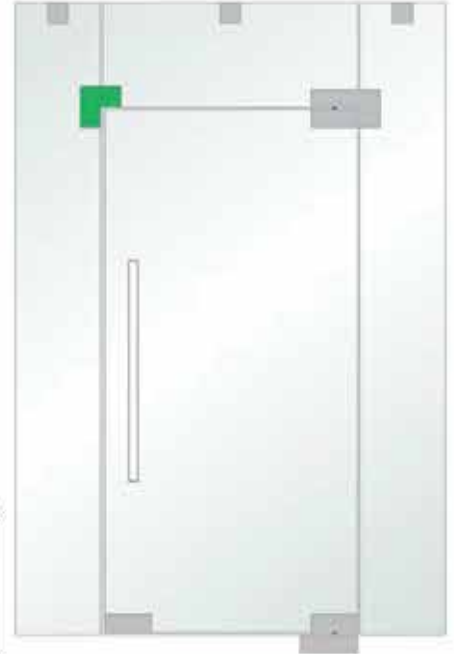
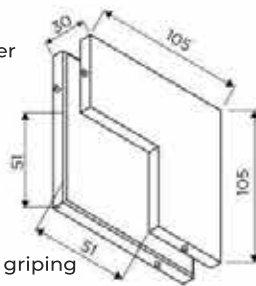
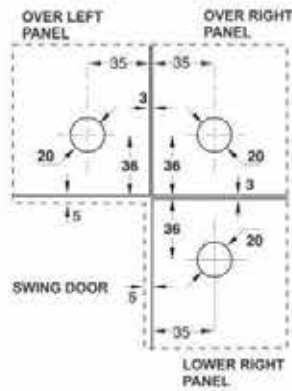

ZPF16

Latch Lock

Suitable to lock swing sliding & sliding doors.

Specifications

- With stainless steel 304 cover
- Can also be use to lock the door from center/top
- Thumb turn lock with single throw
- High quality tampered precision screws are used to ensure solid gripping
- Stainless steel finish

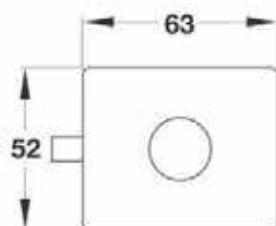



ZPF17

Strike Box for Latch Lock

Suitable as Strike box Swing Sliding Doors

Specifications

- With stainless steel 304 cover
- High quality tampered precision screws are used to ensure solid gripping
- Stainless steel finish

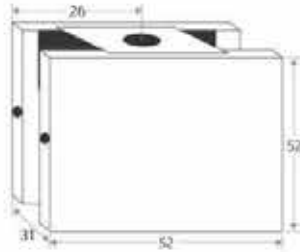
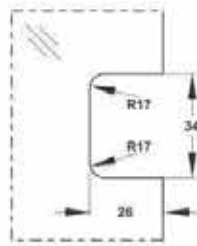

ZPF18

Wall to Glass Connector

To secure glass with a Fixed structure (Ceiling, Floor or Wall)

Specifications

- With stainless steel 304 cover
- Cover secured with small 'L' key
- Stainless steel finish

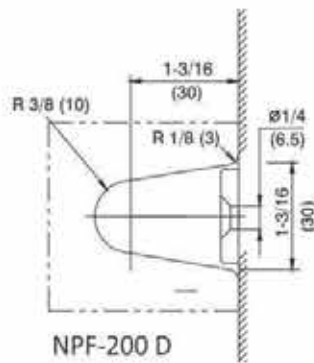
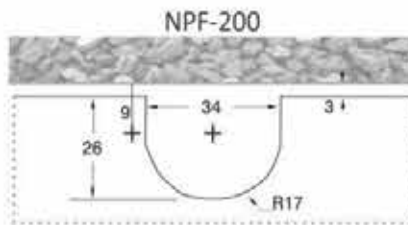

NPF-200 D



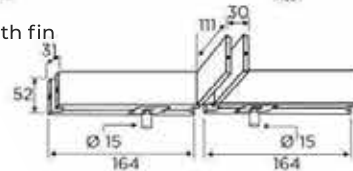
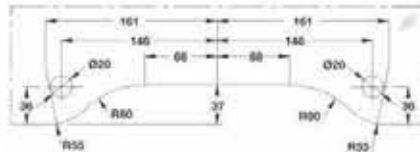
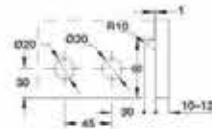

View from outside with Fin on the inside

ZPF19

Double Over Panel Patch with Fin

Suitable for back to back doors with pivot along with fin

Specifications

- With stainless steel 304 cover
- Over panel with pivot for back to back doors
- High quality tampered precision screws are used to ensure solid gripping
- Stainless steel finish

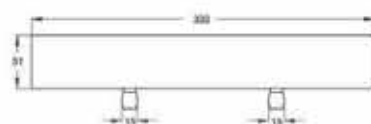

ZPF20

Double Over Panel Patch

Suitable for fixing over panel & side along with fin to be used at the opening top corner of the door.

Specifications

- With stainless steel 304 cover
- L shape from outside with fin inside
- Thumb turn lock with single throw
- High quality tampered precision screws are used to ensure solid gripping
- Stainless steel finish



ZPF21

Floor Bering

Specifications

- With stainless steel 304 cover
- Top View
- High quality tampered precision screws are used to ensure solid gripping
- Stainless steel finish

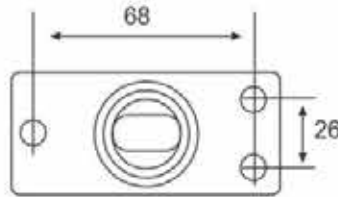

ZPF22

Top Pivot Connector

Top pivot for Patch/Point fitting doors

Specifications

- Stainless Steel Pivot
- Wear resistant stainless steel 304 pivot pin
- Top pivot with 15mm dia. pin
- Pivot held in overhead structure
- Stainless steel finish

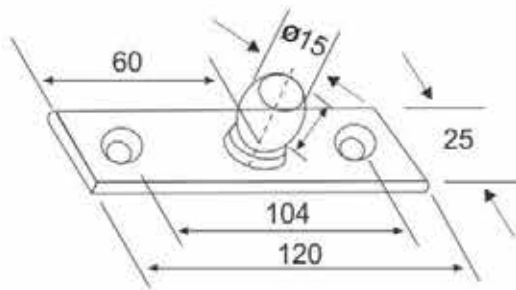

ZPF23

Arm Pivot Set for Wooden & Aluminium Door

Top pivot for Patch/Point fitting doors

Specifications

- Stainless Steel Pivot
- Wear resistant stainless steel 304 pivot pin
- Top pivot with 15mm dia. pin
- Pivot held in overhead structure
- Stainless steel finish

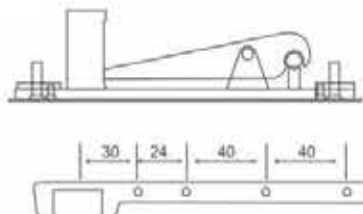



ZGP01

Inter Locking Glazing Profile

Specifications

- For 8 to 12 mm Glass
- Material: Aliminium
- Size: 3000 mm
- Finish: Brush Steel (SS)
Aluminium (ALU)

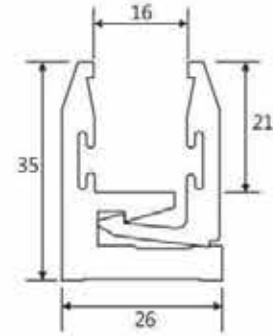

ZGP01

Inter Locking Glazing Profile
(For Insulated & Laminated Glass) for 25mm

Specifications

- For 22 to 26 mm Glass
- Material: Aliminium
- Size: 3000 mm
- Finish: Brush Steel (SS)
Aluminium (ALU)

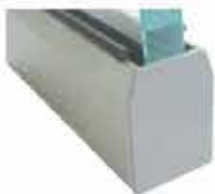
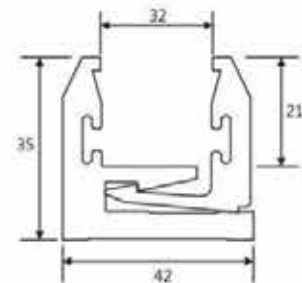

ZGP01

Endcap for Inter Locking Glazing Profile

Specifications

- Endcap foe Inter Locking Glazing Profile NGP-1
- Material: PVC
- Finish: Grey



ZGP01

Endcap for Inter Locking Glazing Profile

Specifications

- Endcap foe Inter Locking Glazing Profile NGP-6
- Material: PVC
- Finish: Grey

- Interior Glass Partitions.
- Interior Office Partitions with multitude of panel Inserts, Glass, MDF, Lamination, Plywood, Gypsum etc.
- Shop Fronts with maximum visibility and security.
- Fixed Windows.

Advantages:

- Simple & faster fabrication and glass installation. ideal for 8, 10 or 12 mm glass thickness.
 - Superior holding power to structure and for glass.
 - No shifting or falling out of position. Maintenance free mechanism.
 - Easy installation & remounting as no glue or silicon required.
 - Easier glass replacement.
 - Cost effective, time & labour saving by easy installation & faster completion of projects.
 - Slim & attractive design, low visual impact, space saving.
 - Deep cavity in profile and uniform grip all along the 8 edges of glass provides outstanding structural stability.
 - Exterior removal of gasket / glass made impossible due to contoured epdm gasket held under pressure.
- Better shock absorption.

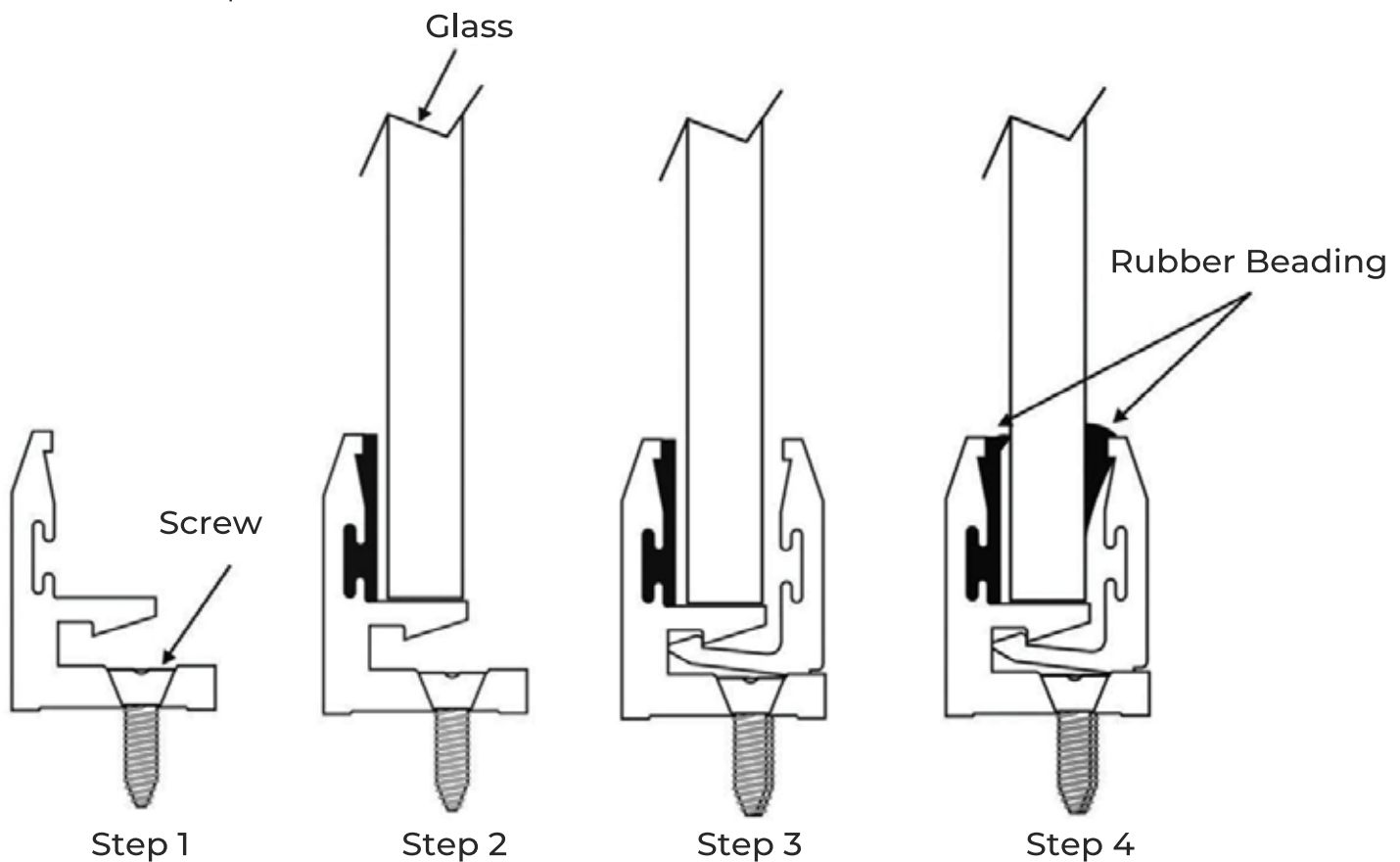

Installation Chart of Inter Locking Glazing Profile



ZITTO High strength die-casting alloy Glass Door Locks. The product features beautiful and grand structure with excellent safeguarding performance. Suitable for tempered glass door 10-15mm thick. Three high-security keys for extra safety are provided for residential and commercial purposes.

Door Locks without Cutout



Silent



Smartness



Long-Lasting





ZDL01
Wall To Glass Lock
Knob

Specification

- Finish: Matt
- One side knob only
- Suitable for 10-12mm Glass
- Glass preparation/ cutout not required
- With gasket to prevent glass from damage
- Suitable for wall/ fix structure to glass

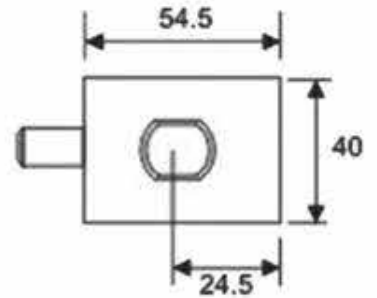

ZDL02
Glass To Glass Lock
Knob

Specification

- Finish: Matt
- One side knob only
- Suitable for 10-12mm Glass
- Glass preparation/cutout not required
- With gasket to prevent glass from damage
- Suitable for glass to glass

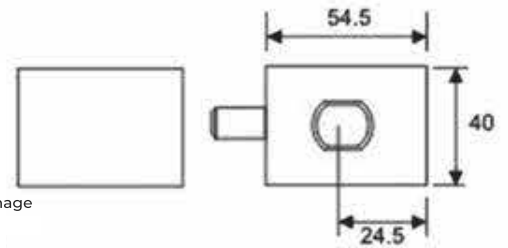

ZDL03
Wall To Glass Lock
(D Type)



(Back Side)

Specification

- Finish: Matt
- One side key one side knob
- Suitable for 10-12mm Glass
- Glass preparation/cutout not required
- With gasket to prevent glass from damage
- Suitable for Wall fix structure to glass
- With three computer Brass Key

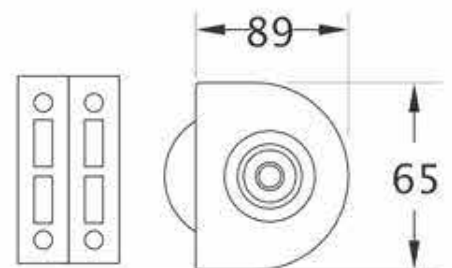

ZDL04
Glass To Glass Lock
(D Type)



(Back Side)

Specification

- Finish: Matt
- One side key one side knob
- Suitable for 10-12mm Glass
- Glass preparation/cutout not required
- With gasket to prevent glass from damage
- Suitable for glass to glass
- With three computer Brass Key

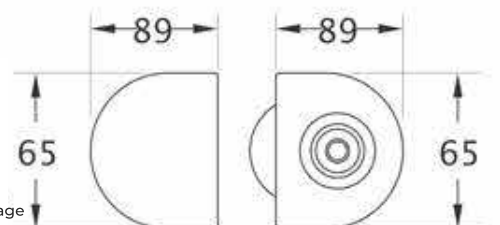

Glass Door Lock



ZDL05
Wall To Glass Lock
Ketchi



- Specification
- Finish: Matt
 - One side key one side knob
 - Suitable for 10-12mm Glass
 - Glass preparation/ cutout not required
 - With gasket to prevent glass from damage
 - Suitable for Wall/ fix structure to glass
 - With three computer Brass Key

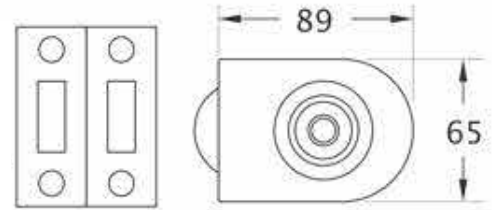

ZDL06
Glass To Glass Lock
Ketchi



- Specification
- Finish: Matt
 - One side key one side knob
 - Suitable for 10-12mm Glass
 - Glass preparation/ cutout not required
 - With gasket to prevent glass from damage
 - Suitable for glass to glass
 - With three computer Brass Key

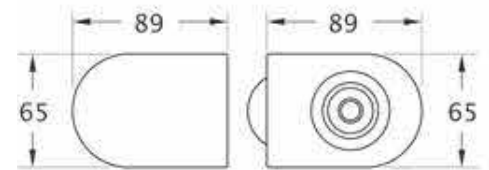

ZDL07
Wall To Glass Lock
One Side



- Specification
- Finish: Matt
 - One side knob only
 - Suitable for 10-12mm Glass
 - Glass preparation/ cutout not required
 - With gasket to prevent glass from damage
 - Suitable for wall fix structure to glass

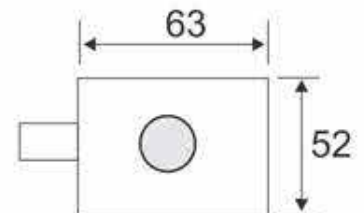

ZDL08
Glass To Glass Lock
One Side



- Specification
- Finish: Matt
 - One side knob only
 - Suitable for 10-12mm Glass
 - Glass preparation/ cutout not required
 - With gasket to prevent glass from damage.
 - Suitable for glass to glass

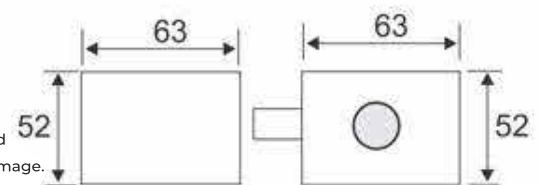



ZDL09
Glass to Glass Lock
Sliding Door

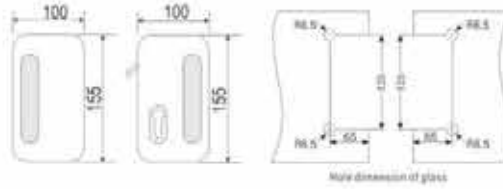

ZDL10
Wall to Glass Lock
Sliding Door

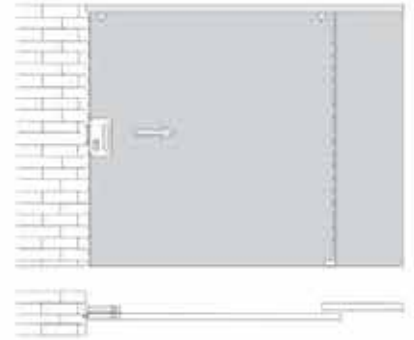
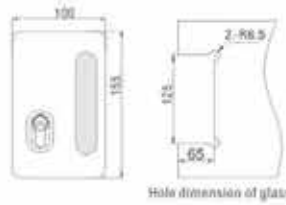

ZDL11 **Sliding Lock**

SPECIFICATION

- Glass to Glass Sliding Lock
- Fit for Glass Thickness : 10mm / 12mm
- Material : SS 304
- Finish : SSS

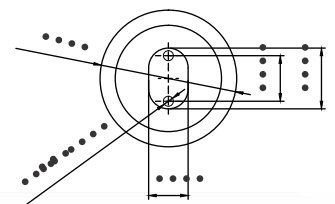
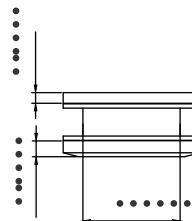
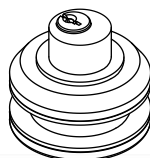
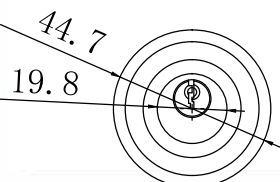
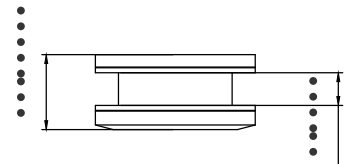
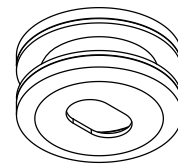
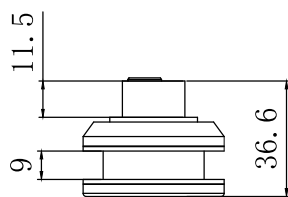
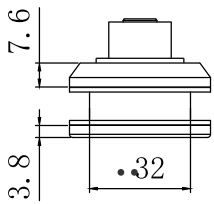



Shower Hinge & Glass Connector



Silent



Smartness



Long-Lasting



Zilito[®]
ACQUEDOTTO ITALIANO
SS 304

Zilito[®]
ACQUEDOTTO ITALIANO
SS 304



ZSH01

Wall to Glass 90° Off Set Hinge
 With gasket to prevent glass from damage
 Secure holding with Glass Double action
 spring returns door from 250 in each direction

Available Finish
 Matt
 Chrome Plated

Material
 Stainless Steel

Door Thickness
 8-12mm

Weight Capacity
 45 Kg

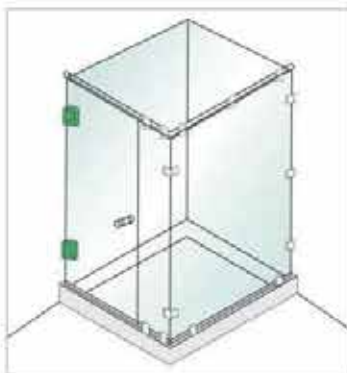
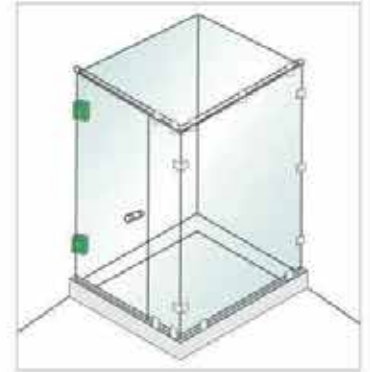
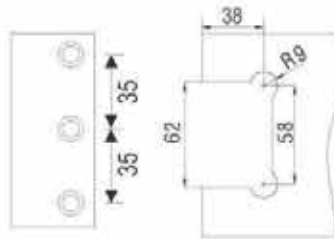

Available Finish
 Matt
 Chrome Plated

Material
 Stainless Steel

Door Thickness
 8-12mm

Weight Capacity
 45 Kg



ZSH02

Wall to Glass 90° Hinge
 With gasket to prevent glass from damage
 Secure holding with Glass
 Double action spring returns door from 25°
 in each direction



ZSH03

Glass to Glass 180° Hinge
 With gasket to prevent glass from damage
 Secure holding with Glass
 Double action spring returns door from 25° in each direction

Available Finish
 Vatt
 Chrome Plated

Material
 Stainless Steel

Door Thickness
 8-12mm

Weight Capacity
 45 Kg

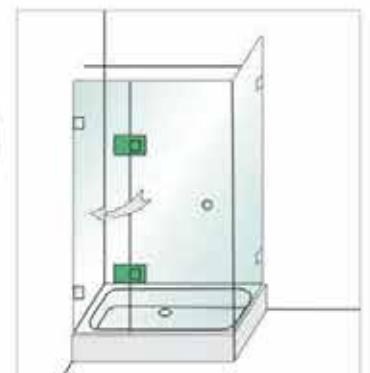
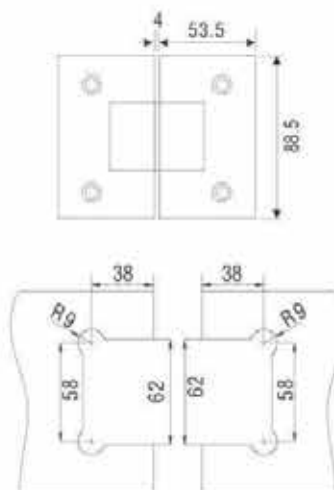



Available Finish
Matt
Chrome Plated

Material
Stainless Steel
ZSH04

Door Thickness
8-12mm

Weight Capacity
45 Kg

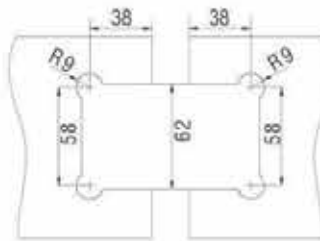
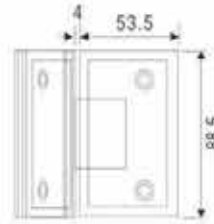

ZSH04

Glass to Glass 135° Off Set Hinge
Secure holding with Glass
With gasket to prevent glass from damage
Double action spring returns door from 250
in each direction

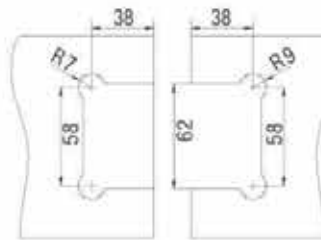
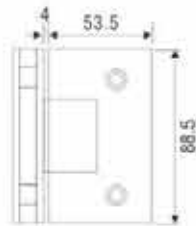
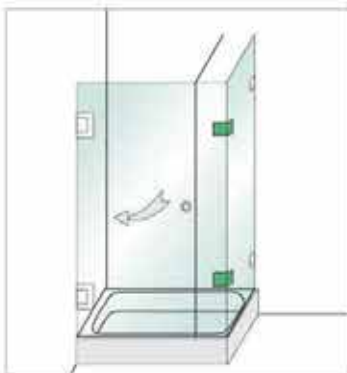

Available Finish
Matt
Chrome Plated

Material
Stainless Steel

Door Thickness
8-12mm

Weight Capacity
45 Kg



ZSH05

Glass to Glass 90° Off Set Hinge
With gasket to prevent glass from damage
Secure holding with Glass
Double action spring returns door from 25°
in each direction



Available Finish
Matt
Chrome Plated

Material
Stainless Steel

Door Thickness
8-12mm

Weight Capacity
45 Kg

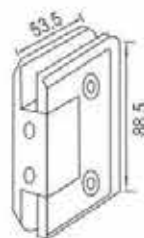

ZSH06

Wall to Glass 90° Hinge Fixed
With gasket to prevent glass from damage
Secure holding with Glass

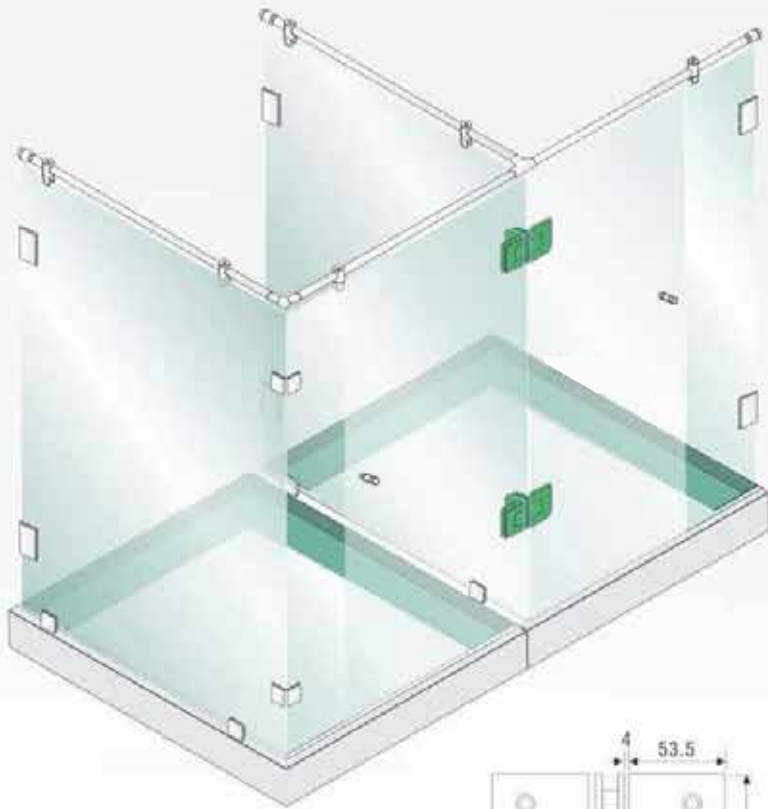

Available Finish
Matt
Chrome Plated

Material
Stainless Steel

Door Thickness
8-12mm

Weight Capacity
45 Kg

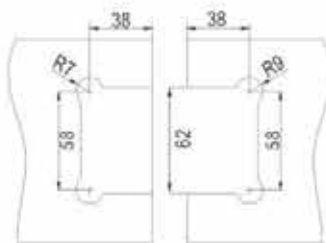
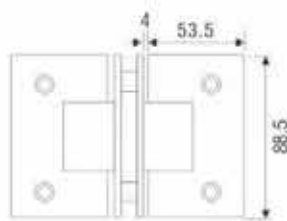

ZSH07

Glass to Glass for 2 Door Hinge
With gasket to prevent glass from damage
Secure holding with Glass
Double action spring returns door from 25°
in each direction



ZSH08

Door Thickness: 6mm to 10mm
Door Weight: Maximum 45 Kg.
Material: Brass
Finish: Bright Chrome

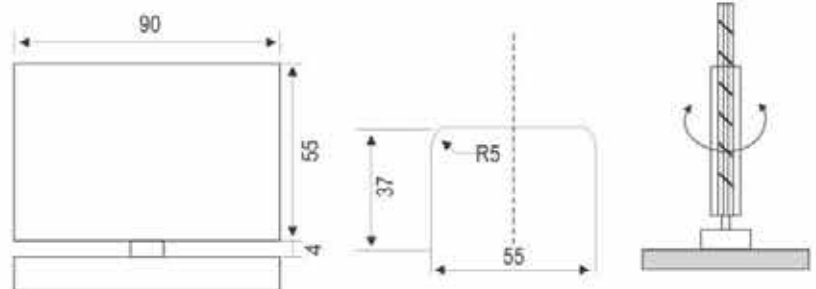



ZC01

Fixed Floor Mounting - 4mm Sheet Metal
With gasket to prevent glass from damage
Secure holding with Glass

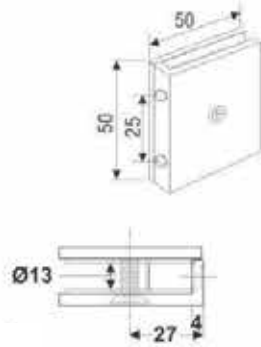

Available Finish
Satin
Glossy

Material
Stainless Steel 304 Grade

Door Thickness
8-12mm

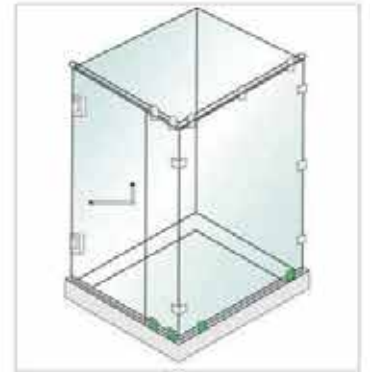

Available Finish
Satin
Glossy

Material
Stainless Steel 304 Grade

Door Thickness
8-12mm

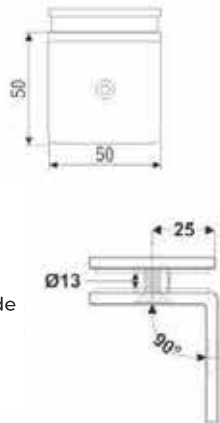

ZC02

Wall to Glass Connector 90°-4mm Sheet Metal
With gasket to prevent glass from damage
Secure holding with Glass



ZC03

Glass to Glass Connector 90° - 4mm Sheet Metal
With gasket to prevent glass from damage
Secure holding with Glass

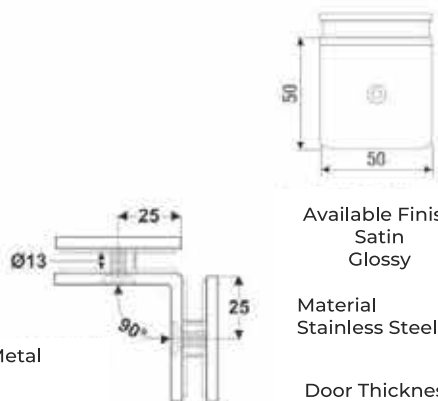

Available Finish
Satin
Glossy

Material
Stainless Steel 304 Grade

Door Thickness
8-12mm



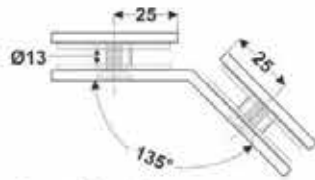

Available Finish
Satin
Glossy

Material
Stainless Steel 304 Grade

Door Thickness
8-12mm



ZC04

Glass to Glass Connector 135°-4mm Sheet Metal
With gasket to prevent glass from damage
Secure holding with Glass

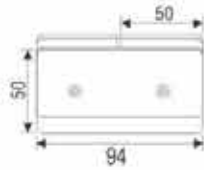

Available Finish
Satin
Glossy

Material
Stainless Steel 304 Grade

Door Thickness
8-12mm

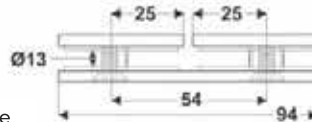

ZC05

Glass to Glass Connector 180°-4mm Sheet Metal
With gasket to prevent glass from damage
Secure holding with Glass

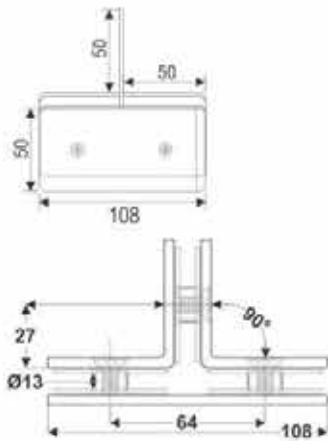

Available Finish
Satin
Glossy

Material
Stainless Steel 304 Grade

Door Thickness
8-12mm



ZC06

Glass to Glass Connector 90° - 4mm Sheet Metal
With gasket to prevent glass from damage
Secure holding with Glass



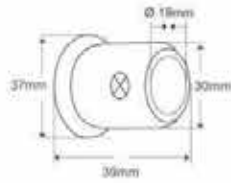

ZSS01

Wall to Rod Holder (for Dia 19mm Rod)

Specifications
Finish: Satin / Glossy
Material: Stainless Steel 304 Grade

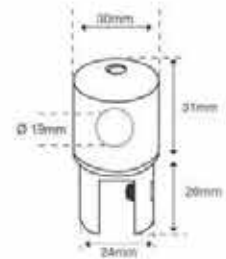

ZSS02

Rod to Glass Holder (for Dia 19mm Rod)

Specifications
Finish: Satin / Glossy
Material: Stainless Steel 304 Grade

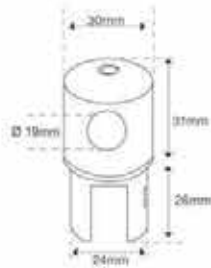

ZSS03

Rod to Glass Holder One Side Blind
(for Dia 19mm Rod)

Specifications
Finish: Satin / Glossy
Material: Stainless Steel 304 Grade

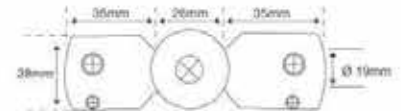

ZSS04

Rod to Rod Holder (for Dia 19mm Rod)

Specifications
Finish: Satin / Glossy
Material: Stainless Steel 304 Grade

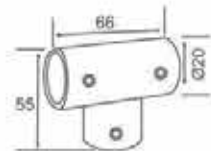

ZSS05

Rod to Rod T Connector (for Dia 19mm Rod)

Specifications
Finish: Satin / Glossy
Material: Stainless Steel 304 Grade



ZSS06

Reinforcing Rod (Dia 19mm)

Specifications
Finish: Satin / Glossy
Material: Stainless Steel 304 Grade



ZITTO Sliding System matched with stainless steel glass door clamp which is most suitable for sliding glass door, whose wheels utilise high strength wear-resistant material, little noise structural design for noiseless operation and durability, Suspension track is made of very high-quality alloy material used in aviation, down holding and cust proof, bearing with extra high weight.

Sliding System



Silent



Smartness



Long-Lasting

ZSR01
Bridge Roller



Sliding Roller

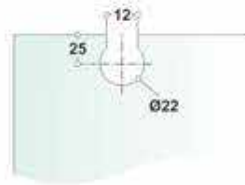

Stopper

Floor Guide

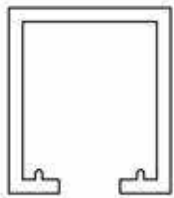

ZSC01

Sliding Track (Sliding only)

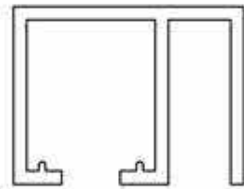

ZSC02

Sliding Track (1Fix+1Sliding)

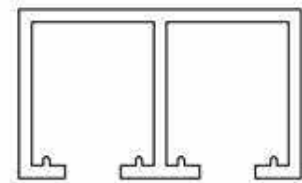

ZSC03

Sliding Track (Double Door)

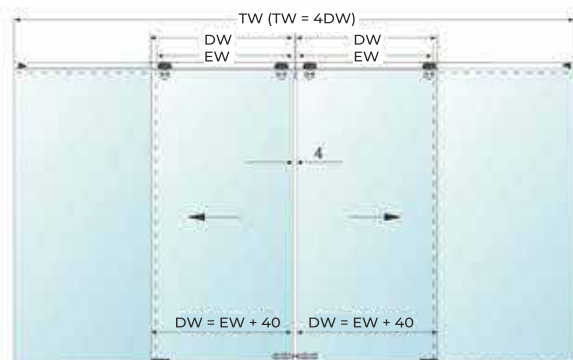
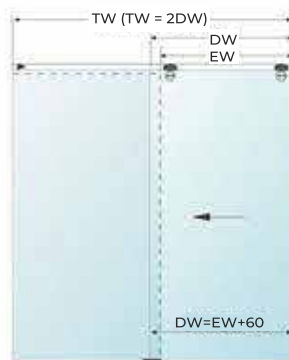
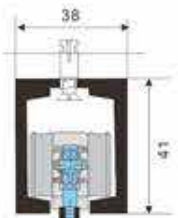

TW= Tube Length DW= Door Width EW= Entry Width

If you need to assemble the lock, please add the width according to the door width and add the needed size of the lock

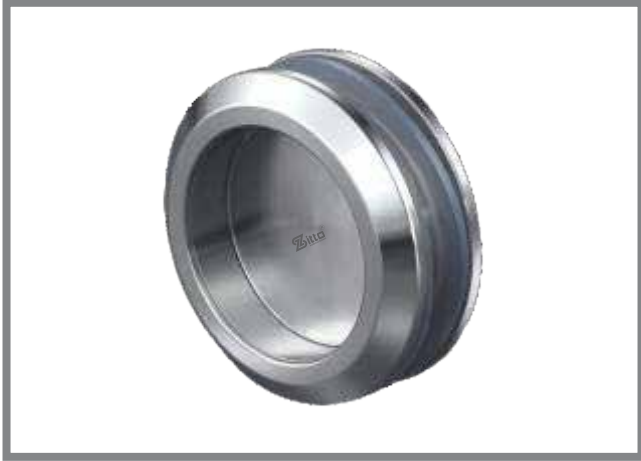

ZSH01

50 mm Round Handle

SPECIFICATION

- Glass Door Handle
- Material : SS 304
- Finish : SSS/PSS

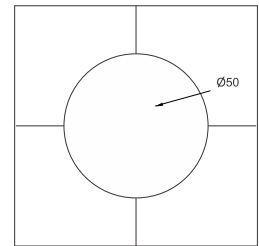
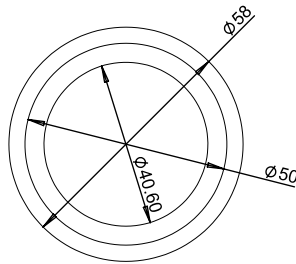

ZSH02

50 mm Round Handle

SPECIFICATION

- Glass Door Handle
- Material : SS 304
- Finish : SSS/PSS

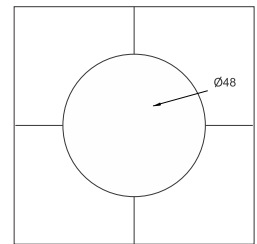
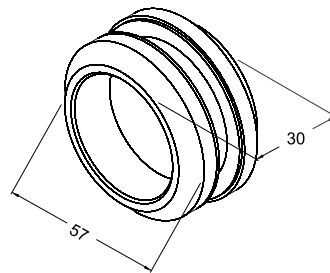

ZSH03

Square Handle

SPECIFICATION

- Glass Door Handle
- Material : SS 304
- Finish : SSS/PSS

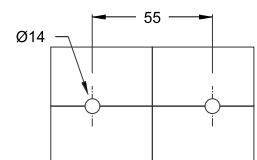
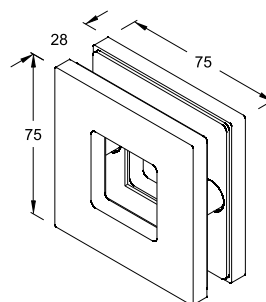



ZSH04

Square Handle

SPECIFICATION

- Glass Door Handle
- Material : SS 304
- Finish : SSS/PSS

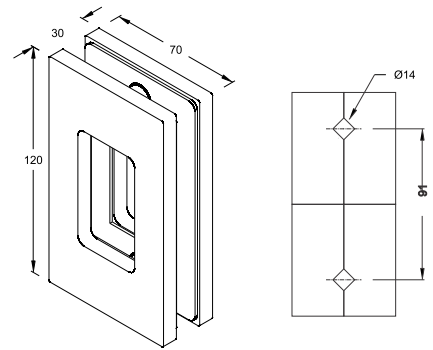

ZSH05

Square Handle

SPECIFICATION

- Glass Door Handle
- Material : SS 304
- Finish : SSS/PSS

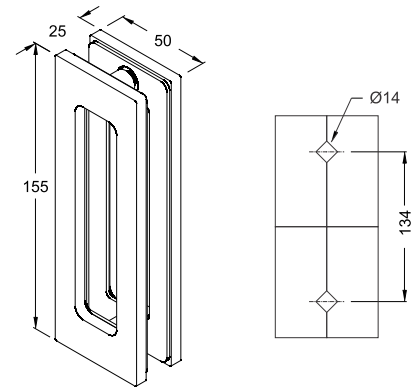

ZGK01

Glass Door Knob

SPECIFICATION

- Knob Handle
- Material : SS 304
- Finish : SSS/PSS

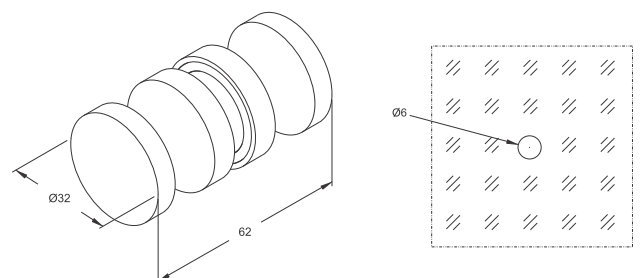

ZGK02

Glass Door Knob

SPECIFICATION

- Knob Handle
- Material : SS 304
- Finish : SSS/PSS

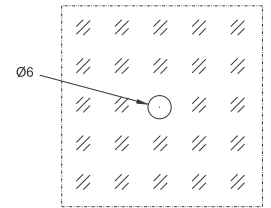
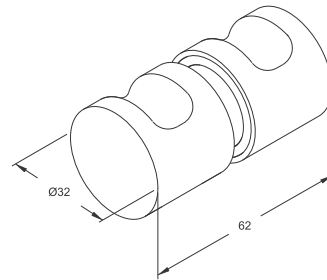



ZSL01 SS 304
Wall to Track Clamp
(L Clamp)



ZSL02
Floor Mount Door Stopper

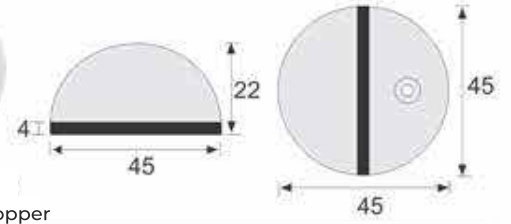

ZSL03 SS 304
Floor Guide

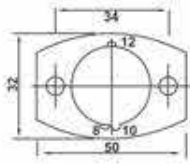

ZSL04 PVC
Sliding Door Stopper

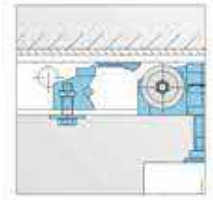

ZSL05 PVC
Wall to Track Connector





Sliding System



ZSR02
Glass Sliding Roller

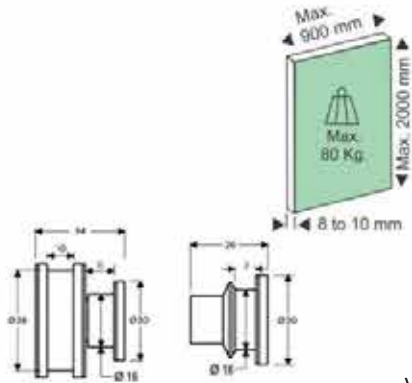

Wall to Track Connector

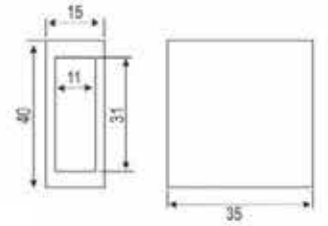
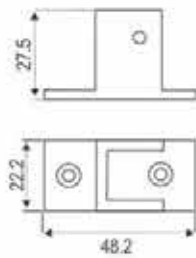
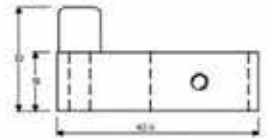

Plate Type Wall Socket



Stopper



Floor Guide

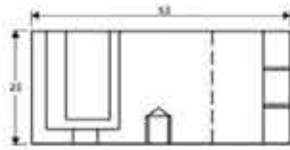

Track to Glass Holder

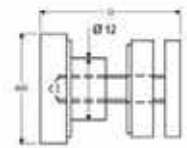

Track to Glass Connector

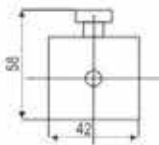

Track to Track Connector 90°

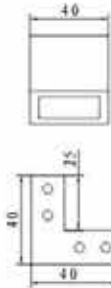

Sliding Track

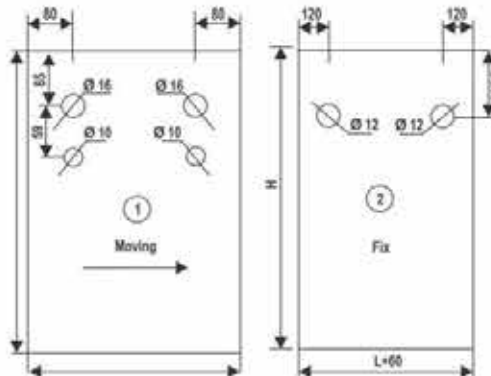
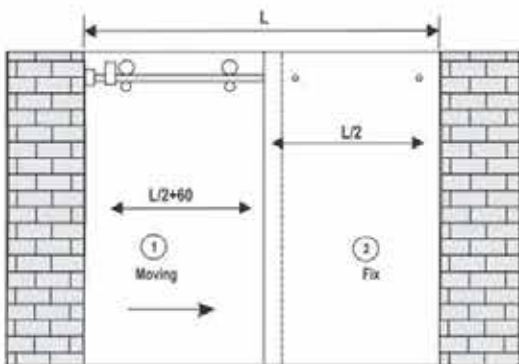

30x10 Square Pipe with Anti-Skid Rod

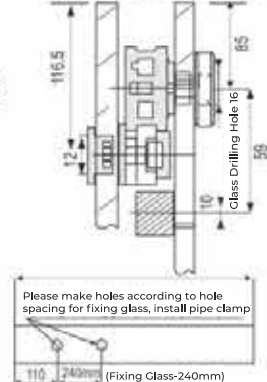

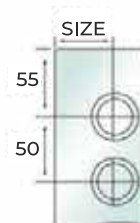
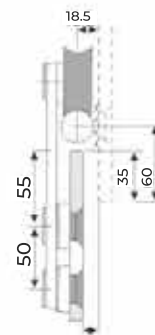
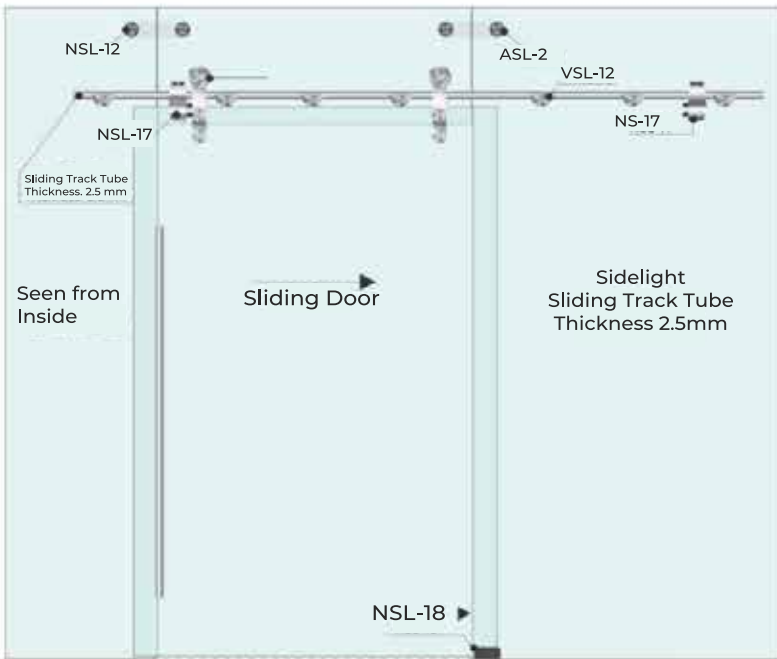



ZSR03
Glass Sliding Roller



Glass Sliding Roller

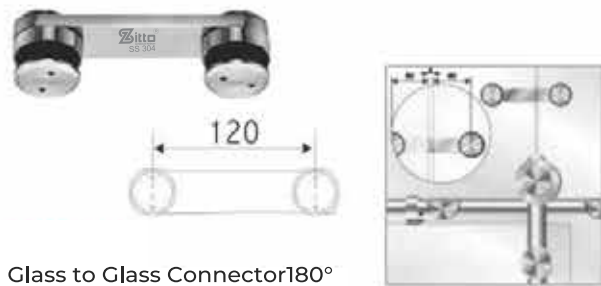

Glass to Glass Connector 180°



Glass to Rod Clamp

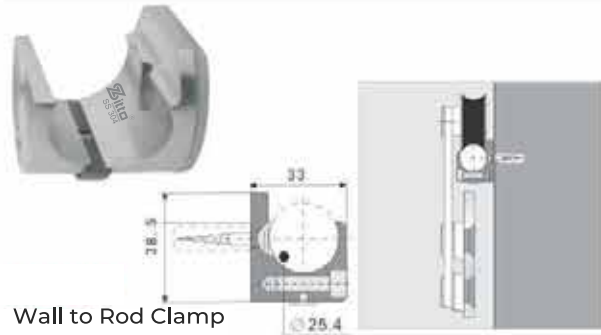

Wall to Rod Clamp

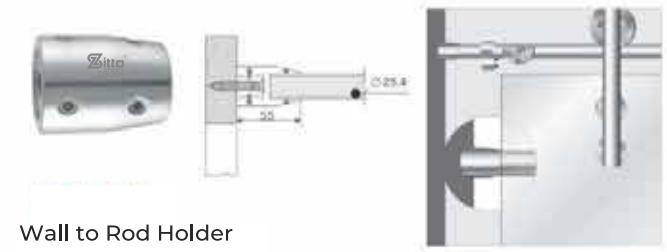

Wall to Rod Holder

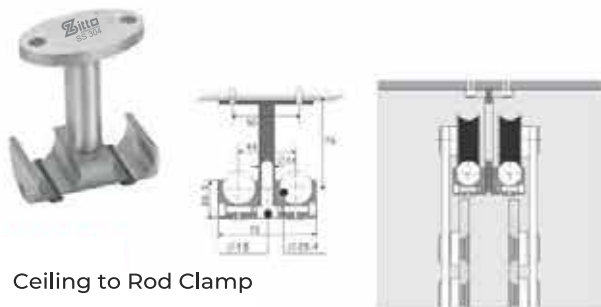

Ceiling to Rod Clamp



Door Stopper (L-R)

PRODUCT MODEL



Sliding Door Floor Guide



Sliding Track Tube



Wall to Track Connector

ZPS01

Magnetic Seal For 90° & 180° Connection

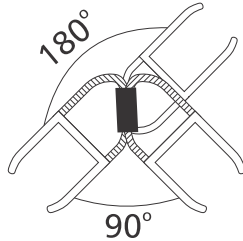

SPECIFICATION

- Material : PVC
- Finish : Transparent
- Glass Thickness : 8,10,12 mm
- Size : 2.2 Mtr.

ZPS02

Magnetic Seal For 135° Connection

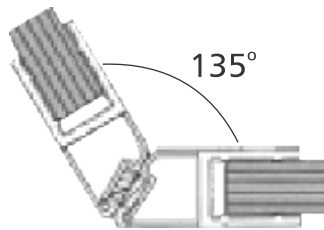

SPECIFICATION

- Material : PVC
- Finish : Transparent
- Glass Thickness : 8,10,12 mm
- Size : 2.2 Mtr.

ZPS03

Central 180° Weather Seal

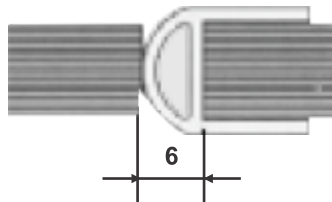

SPECIFICATION

- Material : PVC
- Finish : Transparent
- Glass Thickness : 8,10,12 mm
- Size : 2.2 Mtr.

ZPS04

Wall Seal

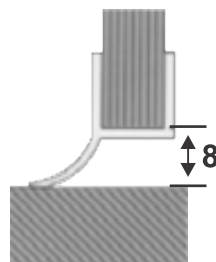

SPECIFICATION

- Material : PVC
- Finish : Transparent
- Glass Thickness : 8,10,12 mm
- Size : 2.2 Mtr.

ZPS05

Central Seal

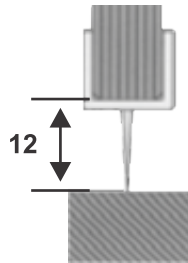
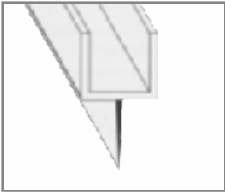

SPECIFICATION

- Material : PVC
- Finish : Transparent
- Glass Thickness : 8,10,12 mm
- Size : 2.2 Mtr.

ZPS06

Central Seal 180° Weather Seal (Soft)

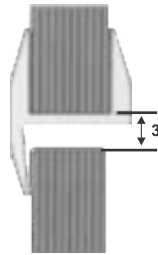
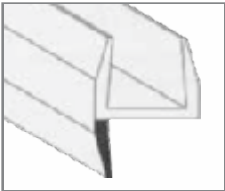

SPECIFICATION

- Material : PVC
- Finish : Transparent
- Glass Thickness : 8,10,12 mm
- Size : 2.2 Mtr.

ZPS07

Offset Lip Seal

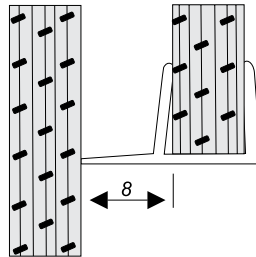
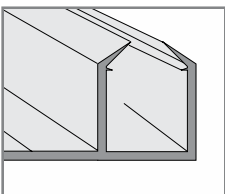

SPECIFICATION

- Material : PVC
- Finish : Transparent
- Glass Thickness : 8,10,12 mm
- Size : 2.2 Mtr.

ZPS08

Offset Lip Seal

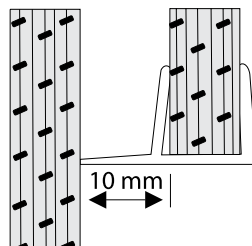
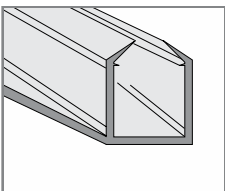

SPECIFICATION

- Material : PVC
- Finish : Transparent
- Glass Thickness : 8,10,12 mm
- Size : 2.2 Mtr.



Door Handles



Silent



Smartness



Long-Lasting

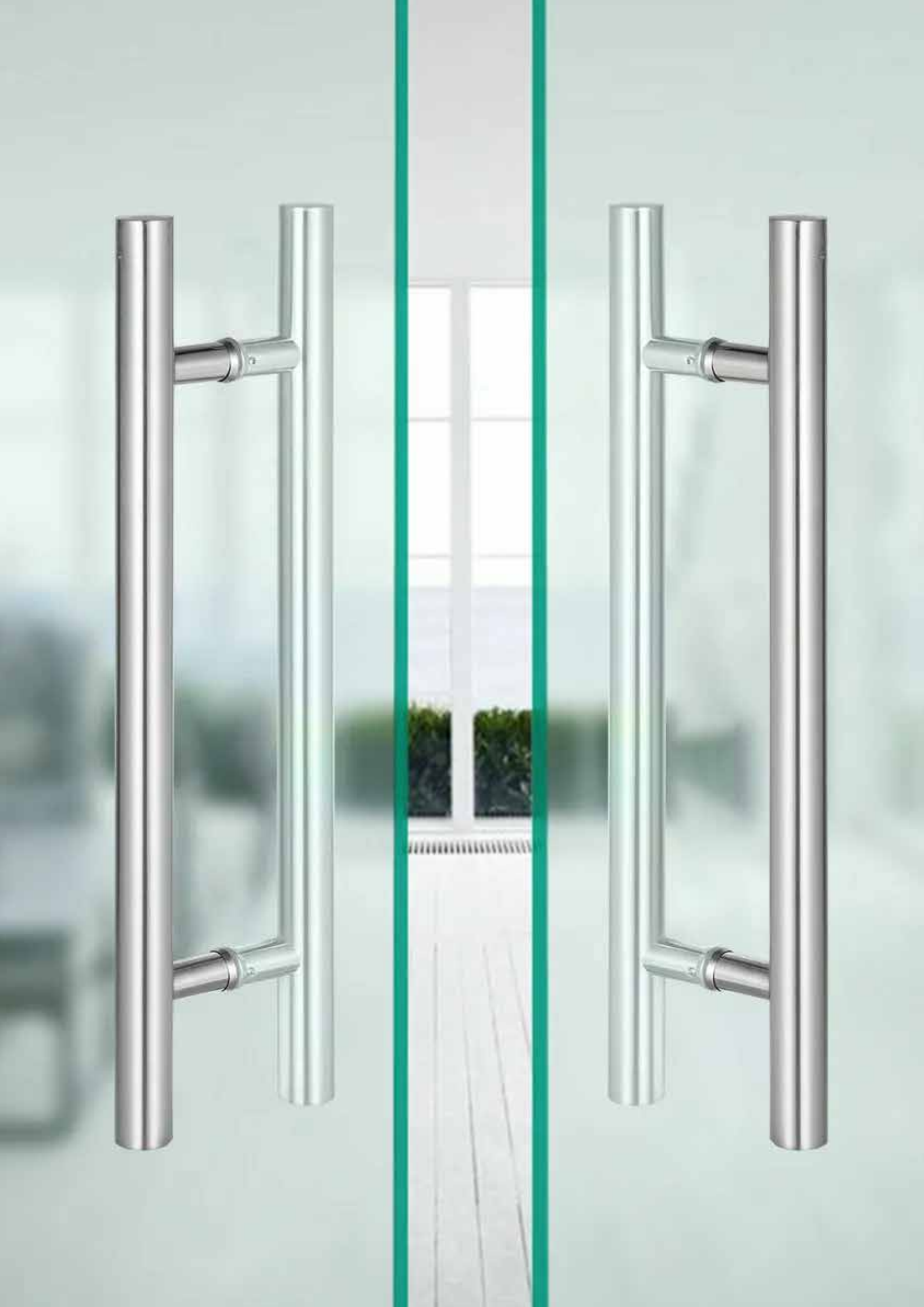

SPECIFICATION

- Glass Door Handle "H" Type
- Material : SS
- Door Thickness : 8mm to 12mm
- Finish : SSS

Product Name	Item Code (L/R)	Overall Length	C to C Hole Dist.	Handle Dia	Finish
Glass Door Handle	ZPH01	457mm	300mm	32mm	SSS
Glass Door Handle	ZPH01	610mm	450mm	32mm	SSS
Glass Door Handle	ZPH01	914mm	600mm	32mm	SSS
Glass Door Handle	ZPH01	305mm	200mm	25mm	SSS

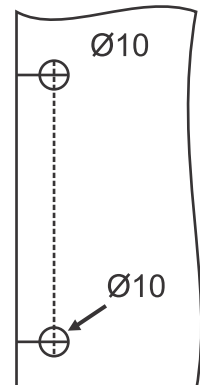
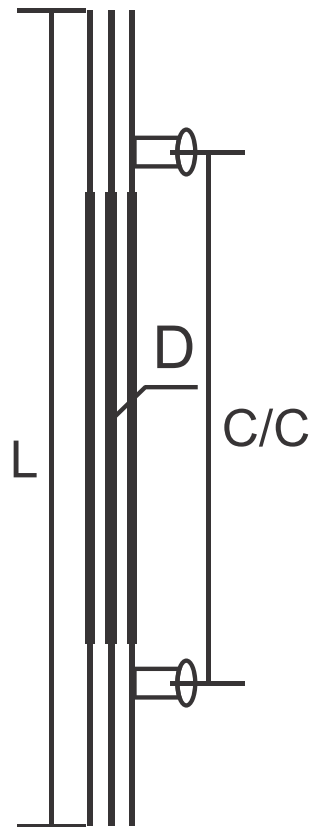

Glass Preparation

SPECIFICATION

- Glass Door Handle "D" Type
- Material : SS
- Door Thickness : 10mm to 12mm
- Finish : SSS

Product Name	Item Code (L/R)	Overall Length	C to C Hole Dist.	Handle Dia	Finish
Glass Door Handle	ZPH02	325mm	300mm	25mm	SSS
Glass Door Handle	ZPH02	225mm	200mm	25mm	SSS

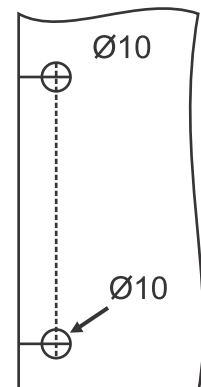
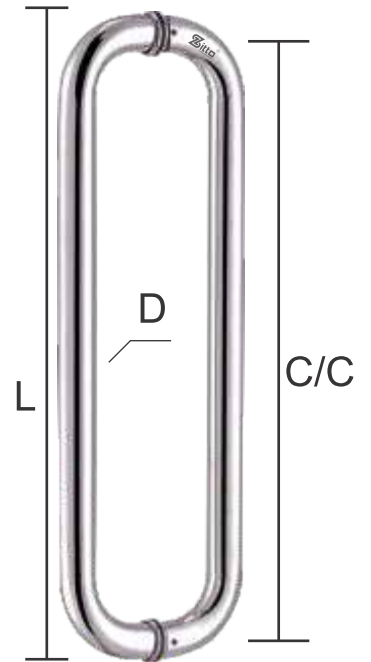

Glass Preparation

SPECIFICATION

- Square Glass Door Pull Handle
- Material : SS
- Glass Door Thickness : 10mm to 12mm
- Finish : SSS

Product Name	Item Code (L/R)	Overall Length (B)	C to C Hole Dist.(A)	Handle Dia (C)	Finish
Square Glass Door Pull Handle	ZPH03	220mm	200mm	25mm	SSS
Square Glass Door Pull Handle	ZPH03	320mm	300mm	25mm	SSS

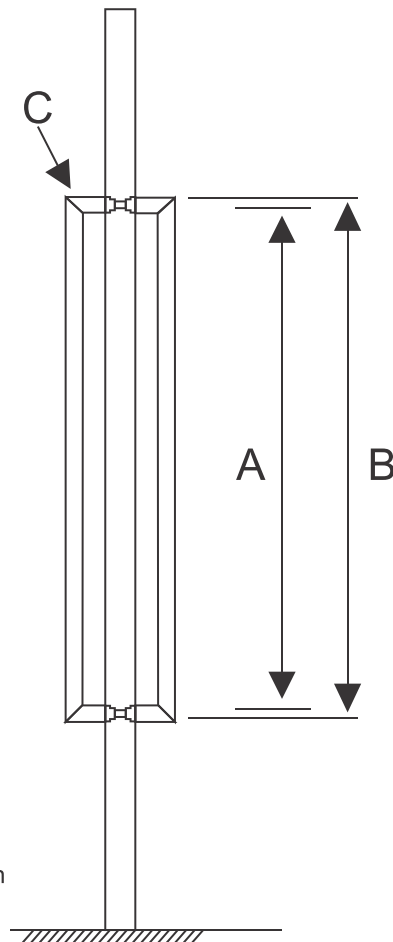
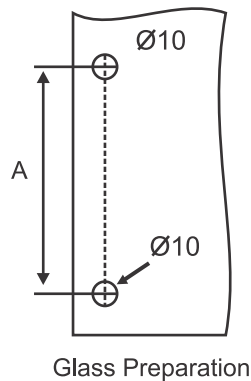

SPECIFICATION

- Glass Door Handle "H" Type with lock
- Material : SS
- Door Thickness : 10mm to 12mm
- Finish : SSS

Product Name	Item Code (L/R)	Overall Length	C to C Hole Dist.	Handle Dia	Finish
Glass Door Handle with Lock	ZPH04	1500mm	1125mm	32mm	SSS

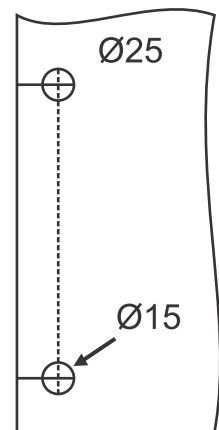
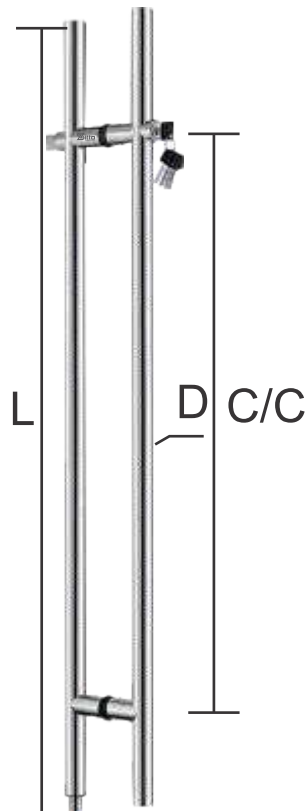

Glass Preparation

SPECIFICATION

- Glass Door Handle
- Material : SS
- Door Thickness : 8mm to 12mm
- Finish : SSS/PSS

Product Name	Product Code	Finish	Size			
			A	B	C	D
Shower Glass Door Handle	ZPH05	SSS / PSS	150	425	22	25
Shower Glass Door Handle	ZPH05	SSS / PSS	150	450	22	25

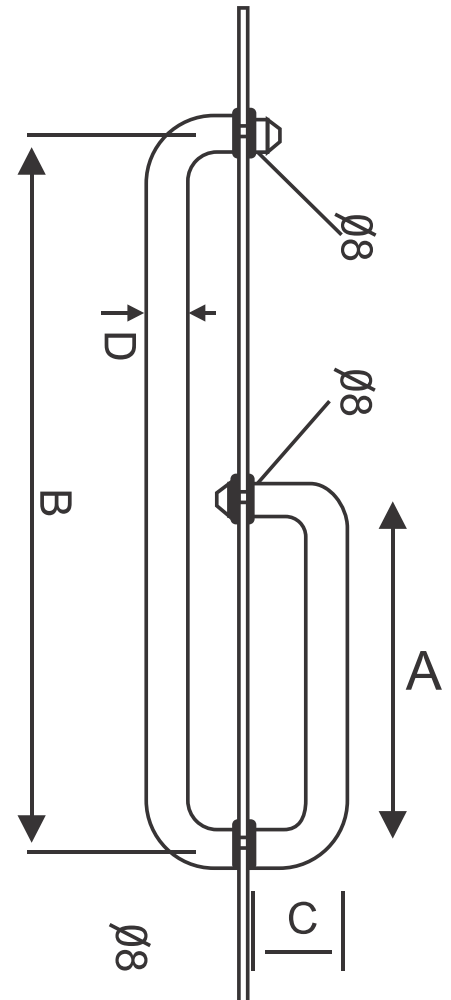



Sliding Folding System



Silent



Smartness



Long-Lasting



Sliding Folding System

PRODUCT DESCRIPTION

- Advanced Folding System for 6 Glass Panels
- Designed for both Interior and Exterior Applications
- Panels are connected using a hinges system
- Premium rollers for easy & smooth running
- Integrated Bolt Lock for Security

Material
Stainless Steel 304

Finish
Satin Stainless Steel (SSS)

GLASS SIDE FOLDING

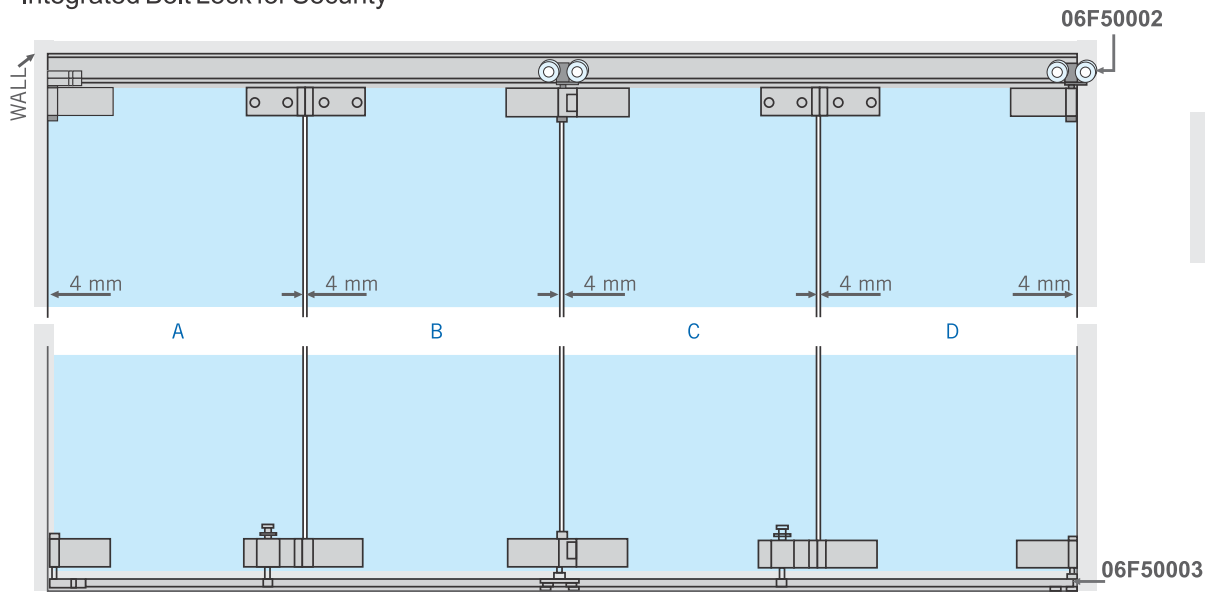
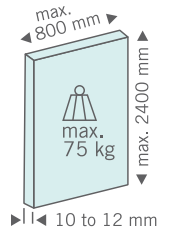

06F50001 P
Start Panel with Top
And Bottom Pivot Device

06F50001 B
Folding Panel with Top
Bottom Hinges, Bottom
Locking Device

06F50001 C
Folding Panel with Top
Roller & Hinges and
Bottom Roller Guide

06F50001 B
Folding Panel with Top
Bottom Hinges, Bottom
Locking Device

06F50001 D
End Panel with Top
And Bottom Roller
Guide

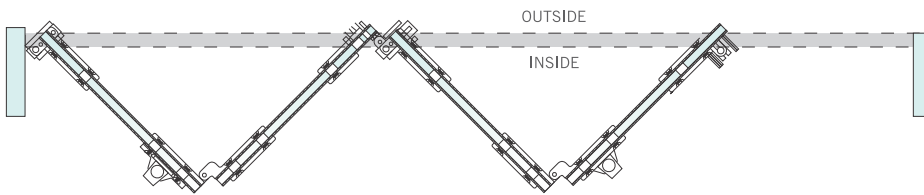
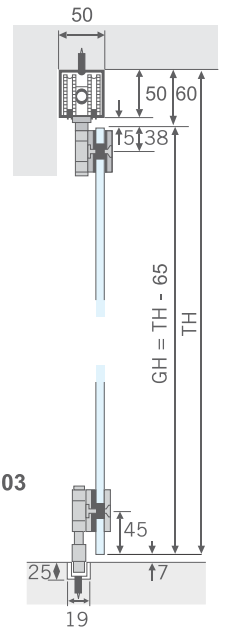

Calculation of Glass weight

Thickness of glass	Approx weight per sq. ft
6mm	1.40 kg
8mm	1.85 kg
10mm	2.35 kg
12mm	2.95 kg

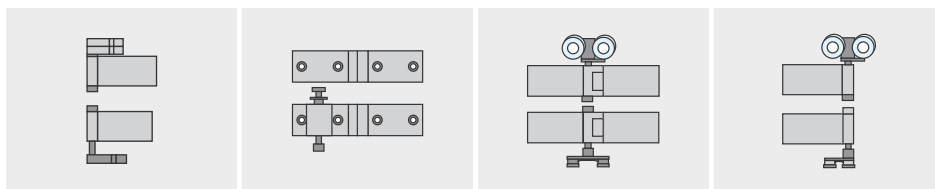

06F50001 P
Top and Bottom Pivot

06F50001 B
Glass to Glass Connector
with Locking Stopper

06F50001 C
Intermediate Roller
with Guide Roller

06F50001 D
End Roller with
Guide Roller

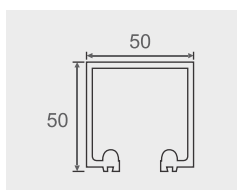

06F50002
Top Aluminium Track
Length : 3600 mm

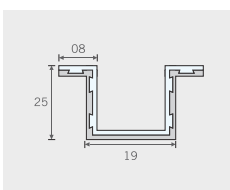

06F50003
Bottom Aluminium Track
Length : 3600 mm

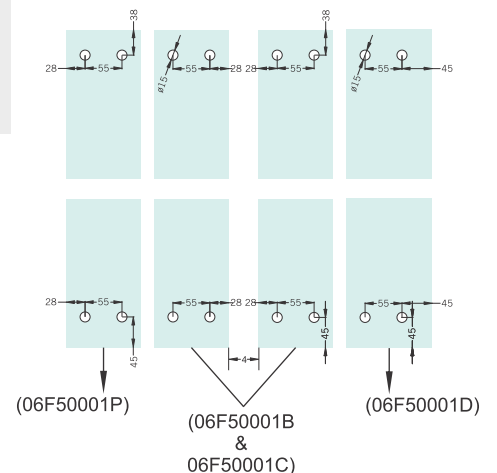

GLASS PREPARATION



PRODUCT DESCRIPTION

- Advanced Glass Centre Folding System for 6 Glass Panels
- Designed for both Interior and Exterior Applications
- Panels are connected using a hinges system
- Premium rollers for easy & smooth running
- Integrated Bolt Lock for Security

Material
Stainless Steel 304

Finish
SSS & PSS

GLASS CENTRE FOLDING

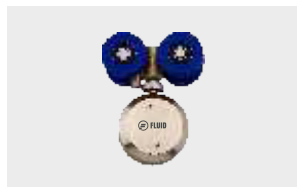
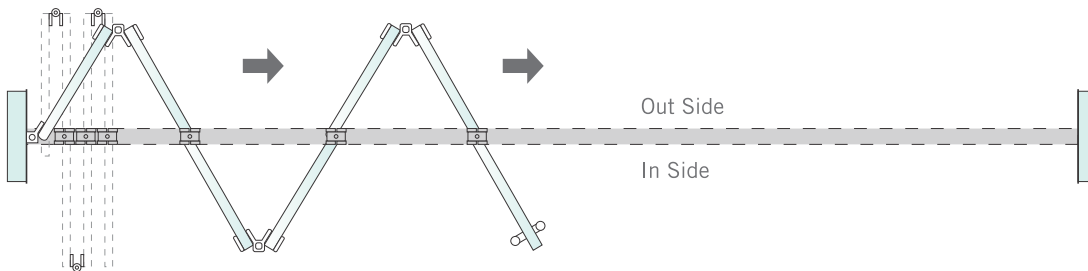
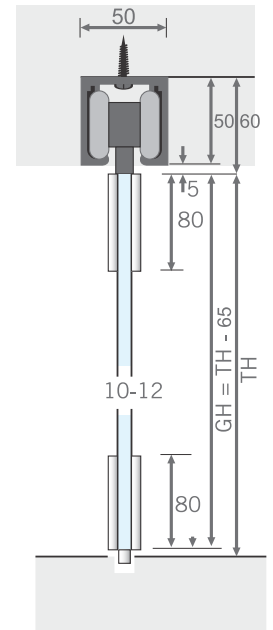
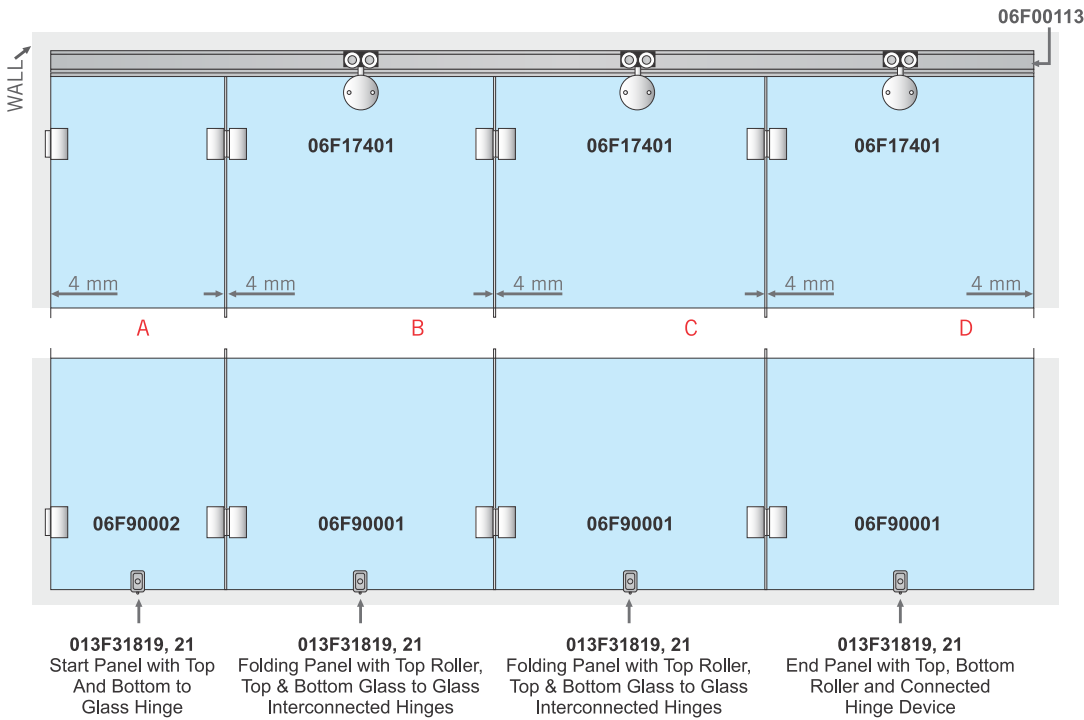
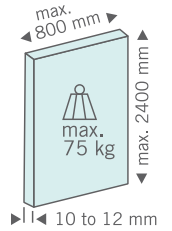

06F17401
Glass Sliding Door Roller



06F90001
Glass to Glass Interconnecting Hinges



06F90002
Wall to Glass Connecting Hinges



013F31819
Turn Knob Bottom Lock



013F31821
Strike Box for 06F31819



06F00113
Aluminium Anodize Top Track
Length : 3600 mm

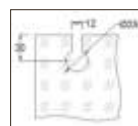

06F17400

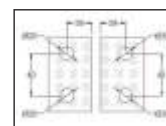

06F90001

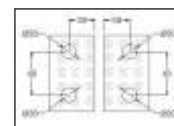

06F90002

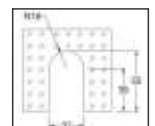

013F31819



Canopy Fittings



Silent



Smartness



Long-Lasting



Single Kit

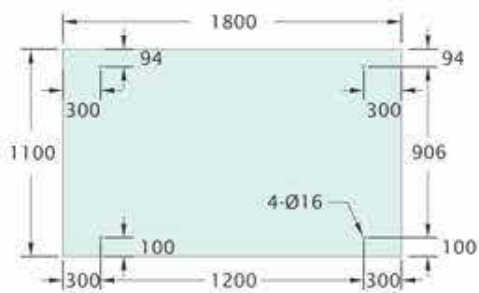

Double Kit

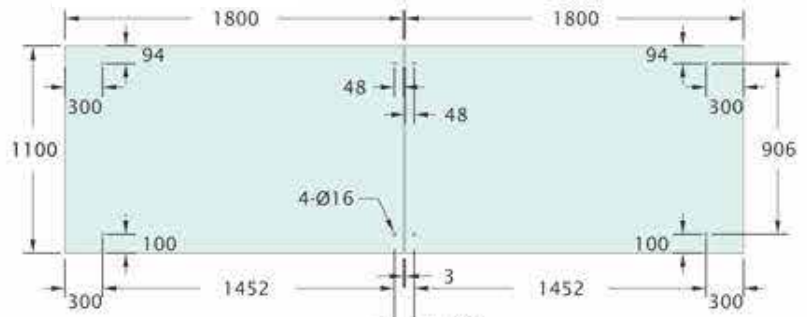

Note

- Toughened Safety Glass 12mm or as required for glazing requirements
- Glass kits available for single canopies or double glass options
- Refer technical page for detail on Glass
- Maximum size as noted
- Canopies can be made as long as required using glass to glass fittings, or multiple single panels
- See over for individual components

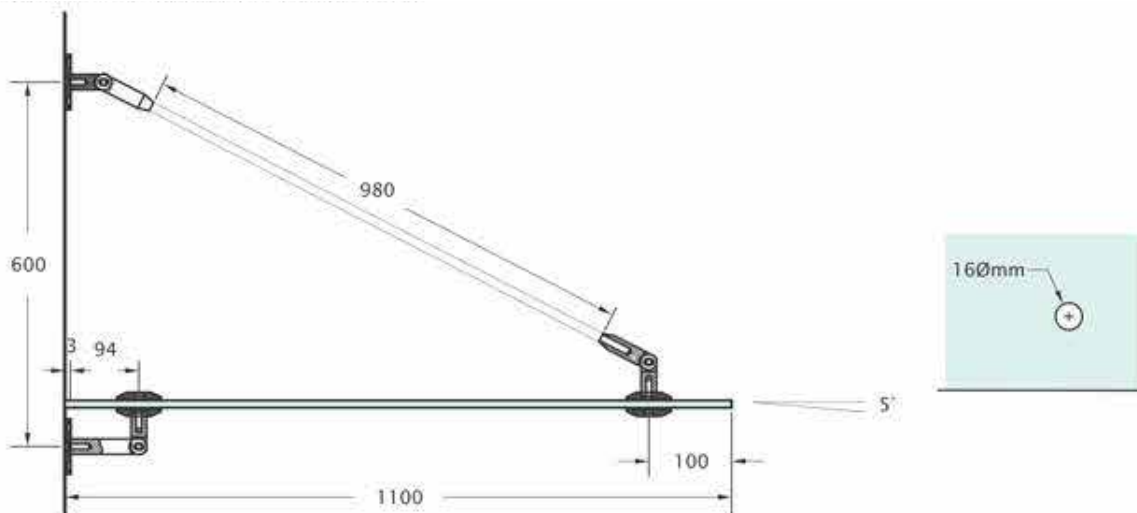



ZCP01
Wall to Rod Canopy fitting

Specification

- Material: Stainless Steel 304
- Finish: Satin stainless steel
- Suitable for holding rod with wall
- Adjustable angle
- Washer to prevent glass from damage

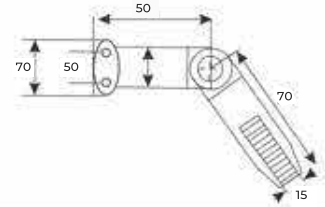

ZCP02
Rod to Glass Canopy fitting

Specification

- Material: Stainless Steel 304
- Finish: Satin stainless steel
- To hold canopy glass with rod
- Adjustable angle
- Washer to prevent glass from damage

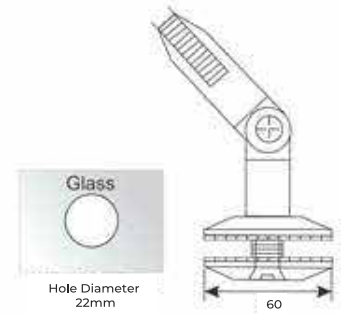

ZCP03
Wall to Glass Canopy fitting

Specification

- Material: Stainless Steel 304
- Finish: Satin stainless steel
- To fix glass with wall
- Adjustable angle
- Washer to prevent glass from damage

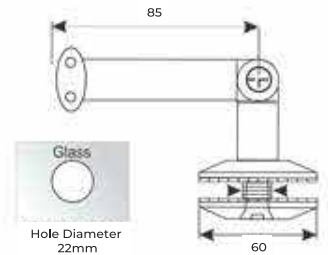

ZCP04
Connecting Rod Canopy fitting

Specification

- Material: Stainless Steel 304
- Finish: Satin stainless steel
- To be fix to secured glass
- To be used with AR-CF-11 and AR-CF-12

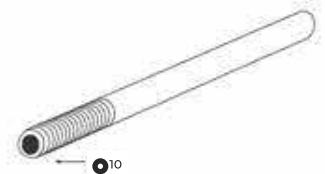

NOTES:





RUSHIL ENTERPRISE

Contact Us :

 (+91) 9833399671 / (+91) 9409544602

 zittoimpex@gmail.com

 Opp. New Police Line, Ambawadi, Mahavirnagar,
Himmatnagar, -383001, Dist: Sabarkantha, Gujarat (India)